

© This Drawing is the copyright of benjamin + beauchamp architects ltd.  
All dimensions to be checked on site by contractor and not scaled from this drawing.  
benjamin + beauchamp architects ltd accept no liability for any expense, loss or damage of whatsoever nature and however arising from any variation made to the drawing or in the execution of the work to which it relates, which has not been referred to them and their approval obtained.

SEATING	
Approximate reduction of seating by pew removal:	70-80
Proposed number of new Howe 40/40 chairs:	79

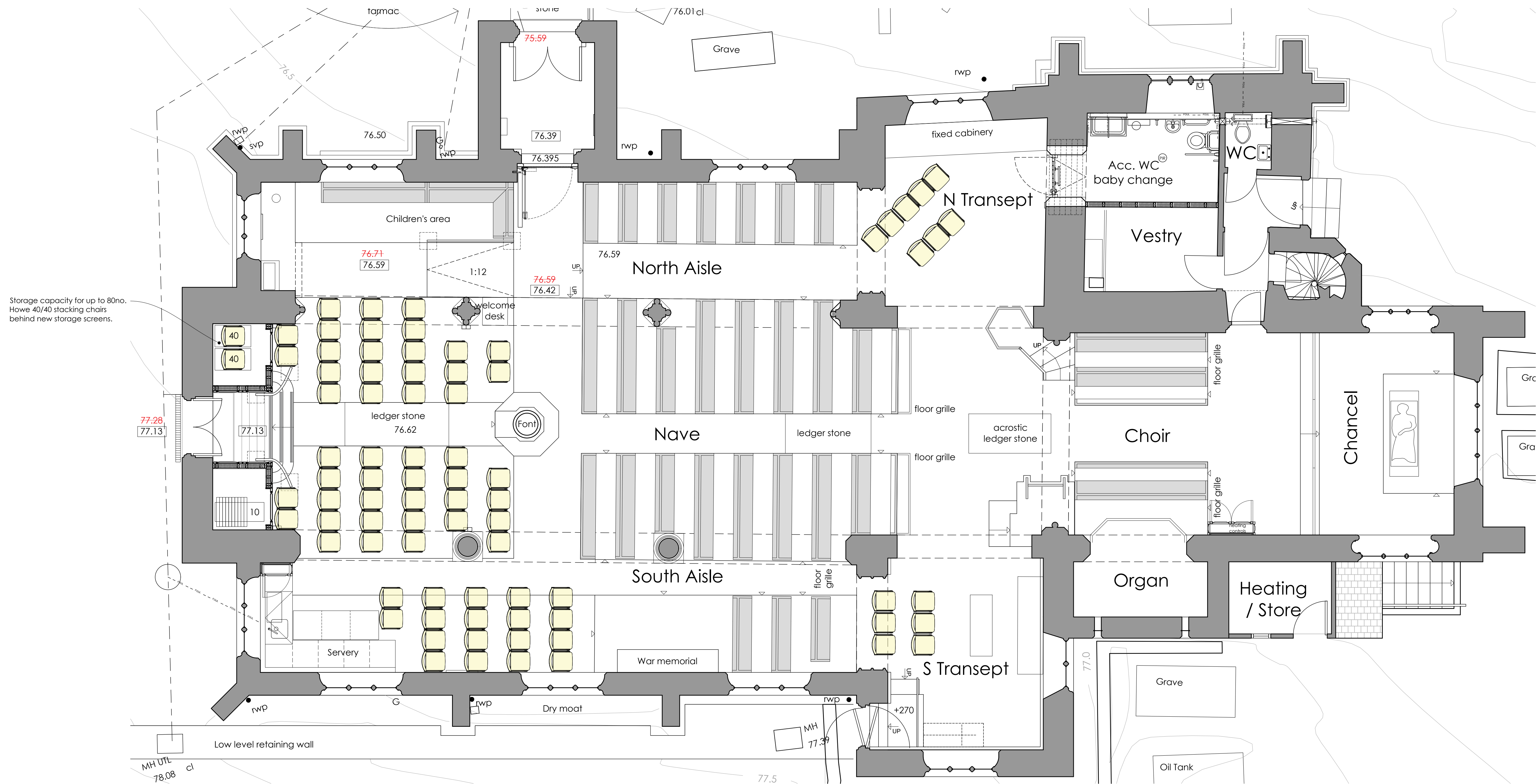

1:50  
metres

**benjamin + beauchamp**  
architecture design conservation  
the borough studios, the borough,  
wedmore, somerset BS28 4EB  
T 01934 713313 F 01934 713314

Project  
**EAST COKER St Michael and All Angels**

Title  
**Proposed Seating Plan**

Stage  
**WORKING DRAWING**

Drawn by	Date	Scale
mh	06.10.25	1:50 at A1

Revision Date Initials Notes

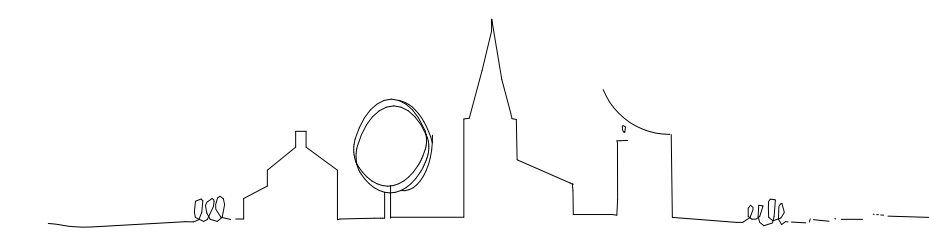

Drawing No.

**0659.WD.050 -**

studio@b2architects.com www.b2architects.com

P:\East Coker - St Michael and All Angels - 0659\Drawings - Photos & Graphics\B2 Drawings\Drawing board\WORKING DRAWINGS\0659.WD.050 Proposed Seating Layout.dwg