

Proposed Plan 1:10@A1

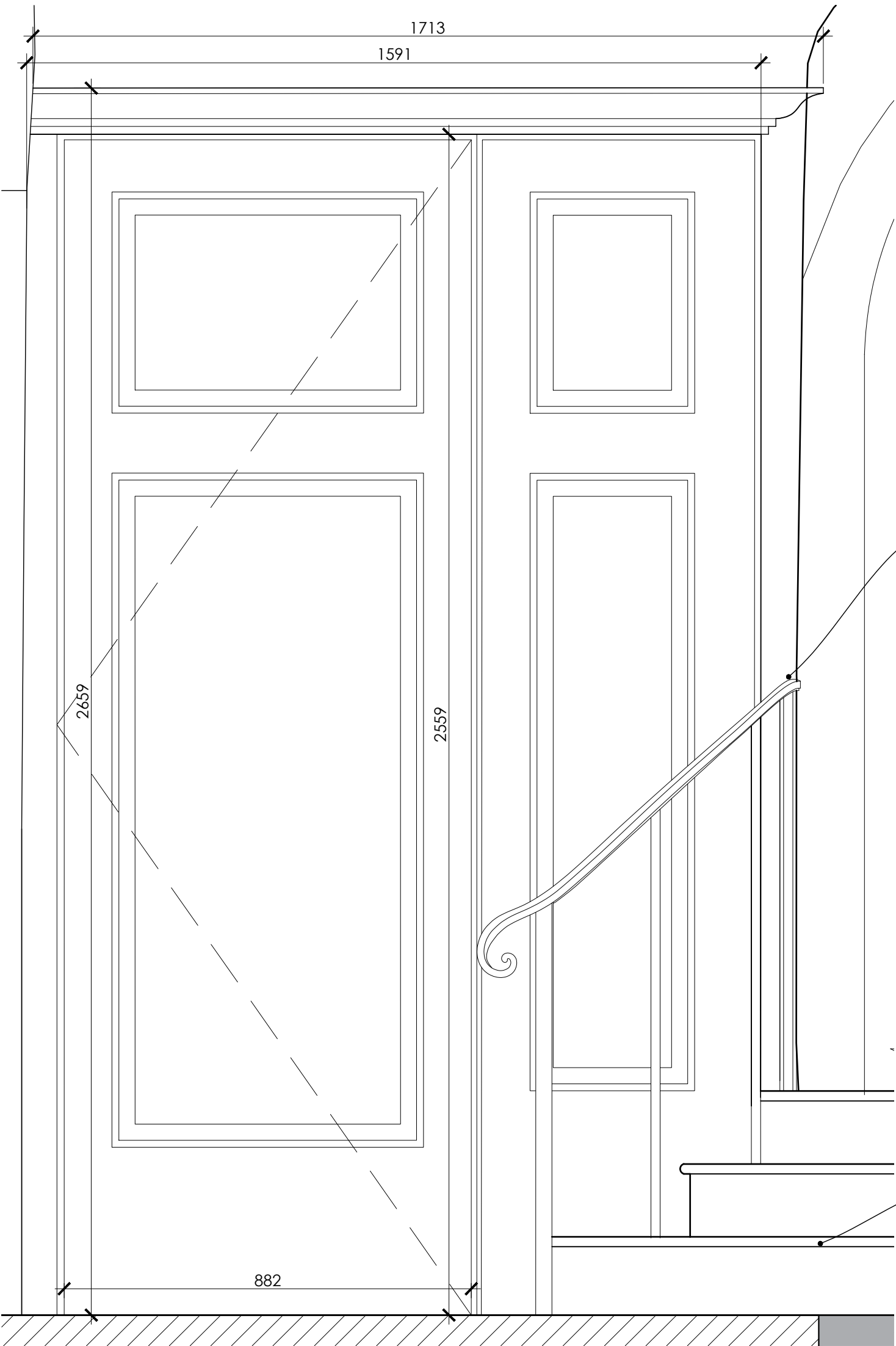

Proposed Front Elevation 1:10@A1

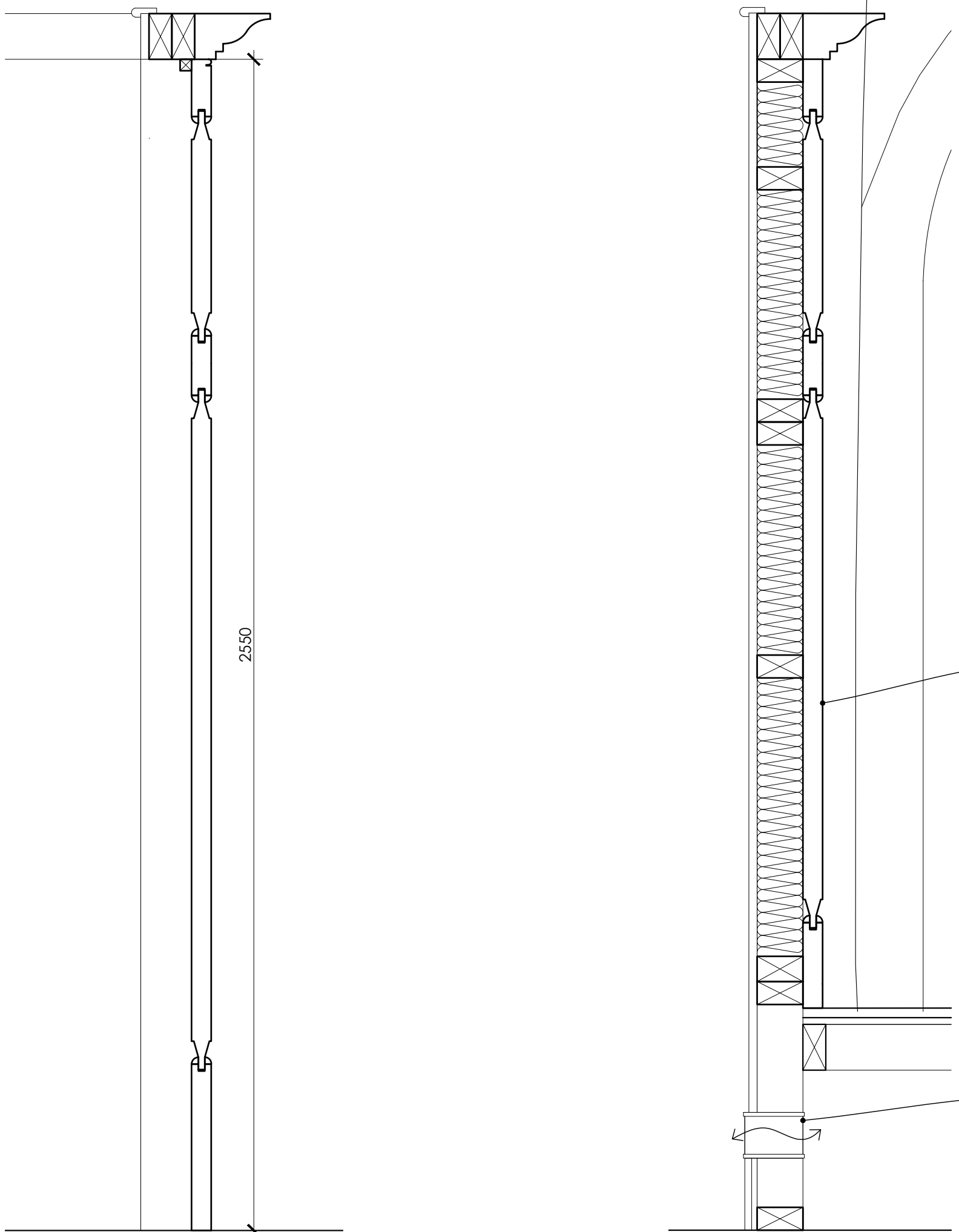

Proposed Section AA 1:10@A1

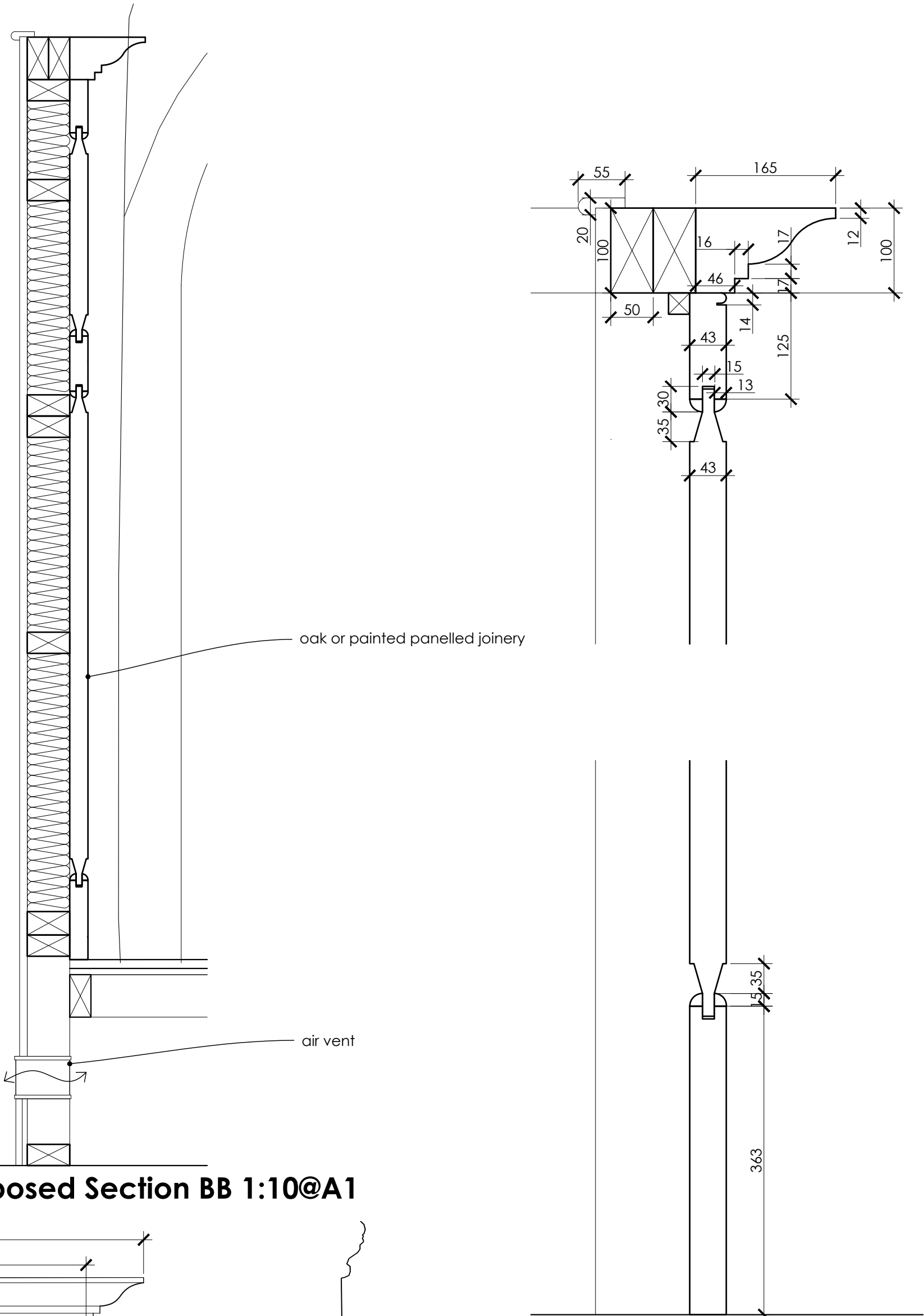

Proposed Section BB 1:10@A1

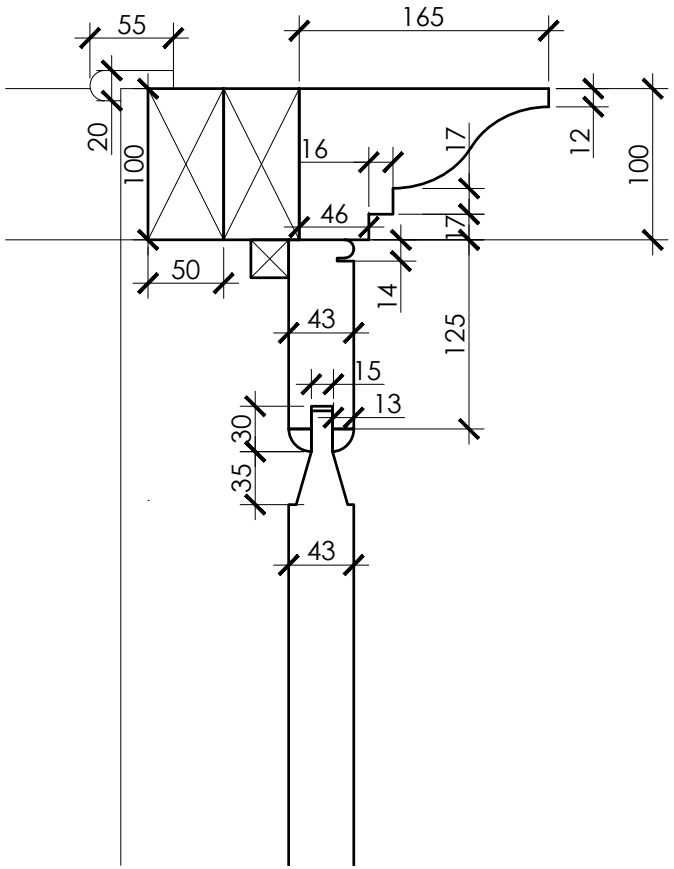

Detail Panelled Door Section AA 1:5@A1

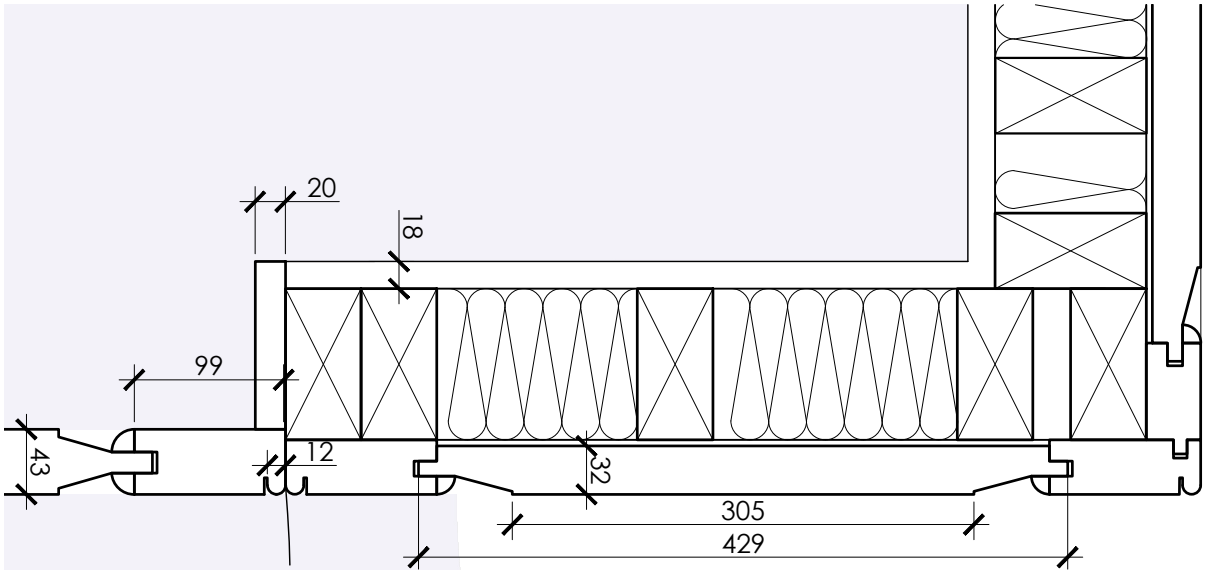

Detail Paneling in Plan 1:5@A1

© This Drawing is the copyright of benjamin + beauchamp architects ltd.  
All dimensions to be checked on site by contractor and not scaled from this drawing. Scaling for planning purposes only.  
benjamin + beauchamp architects ltd accept no liability for any expense, loss or damage of whatsoever nature and however arising from any variation made to this drawing or in the execution of the work to which it relates, which has not been referred to them and their approval obtained.  
p:\east coker - st michael and all angels - 0609\drawings, photos & graphics\02 drawings\drawing board\working drawings\0609-wd.032 proposed storage screens joinery details.dwg

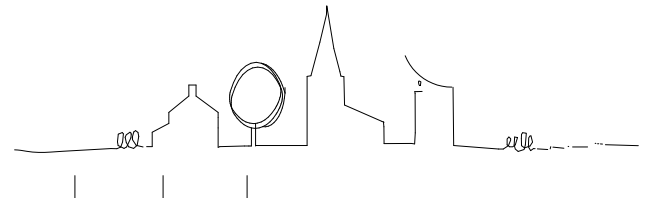
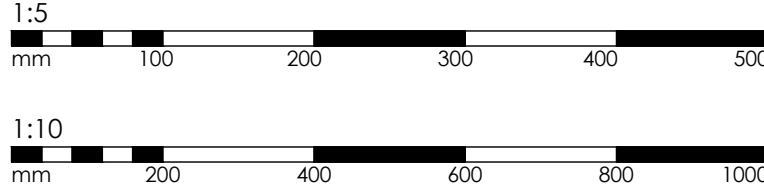

EAST COKER -  
St Michael and All Angels

Proposed Storage  
Screens Joinery Details

WORKING DRAWINGS

benjamin + beauchamp  
architecture design conservation  
the borough studios, the borough,  
wedmore, somerset BS28 4EB  
T 01934 713313 F 01934 713314

Drawn By: 03.09.25 Scale: varies at A1  
Drawing No: 0659WD.032 A  
Media: b2architects.com www.b2architects.com



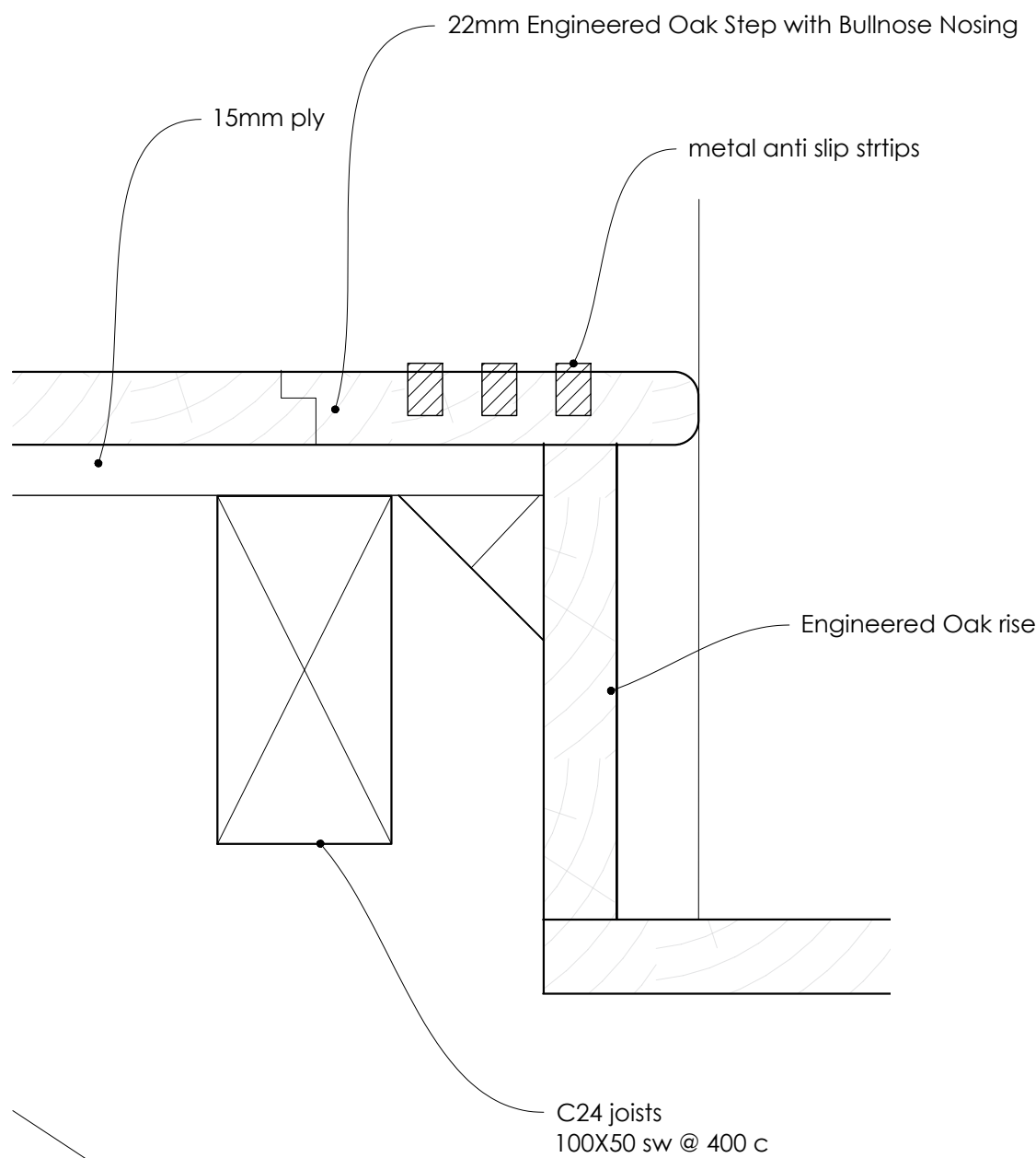

W End Steps -  
Detail 1:2@A1

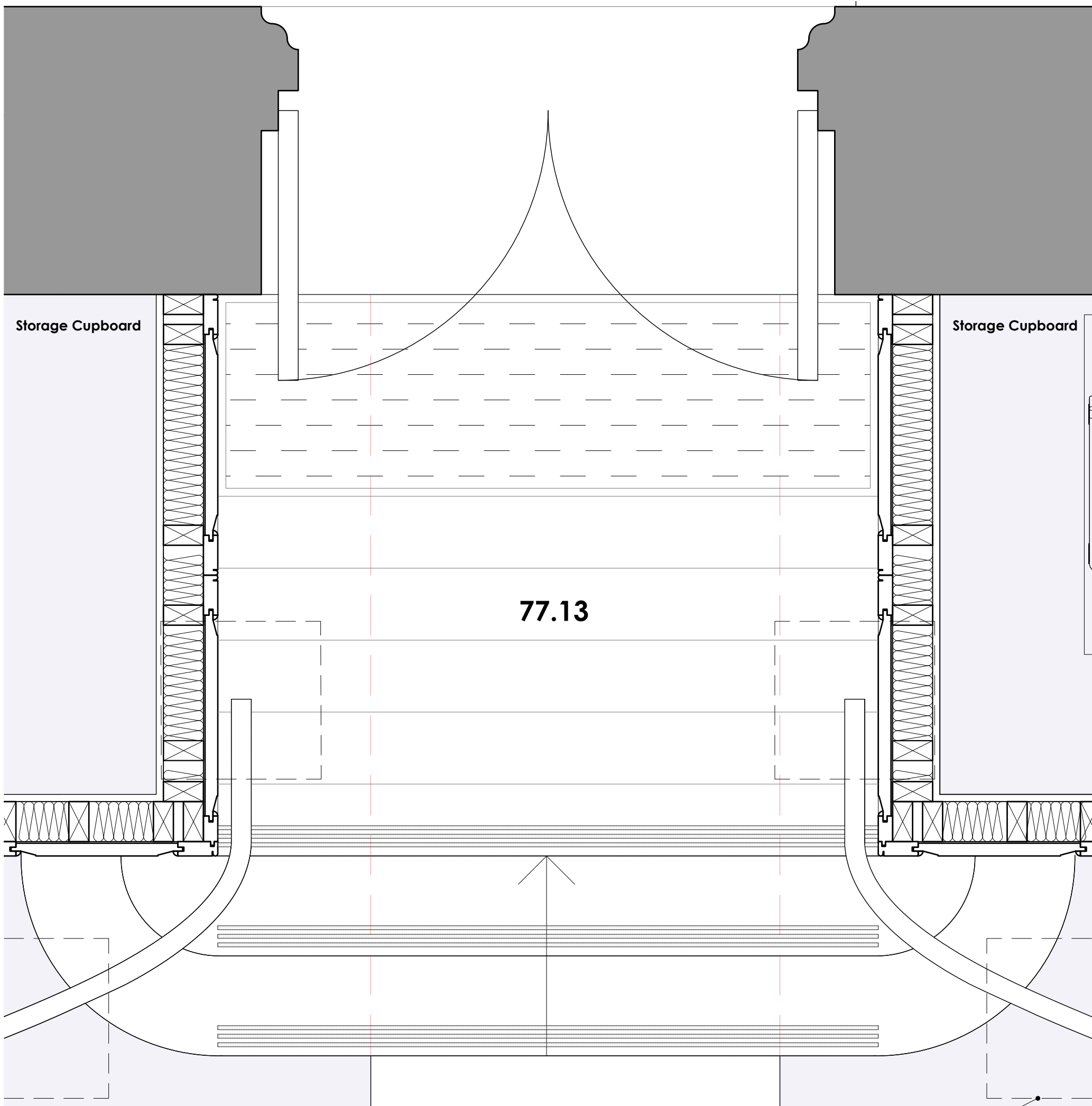

W End Steps - Plan 1:10@A1

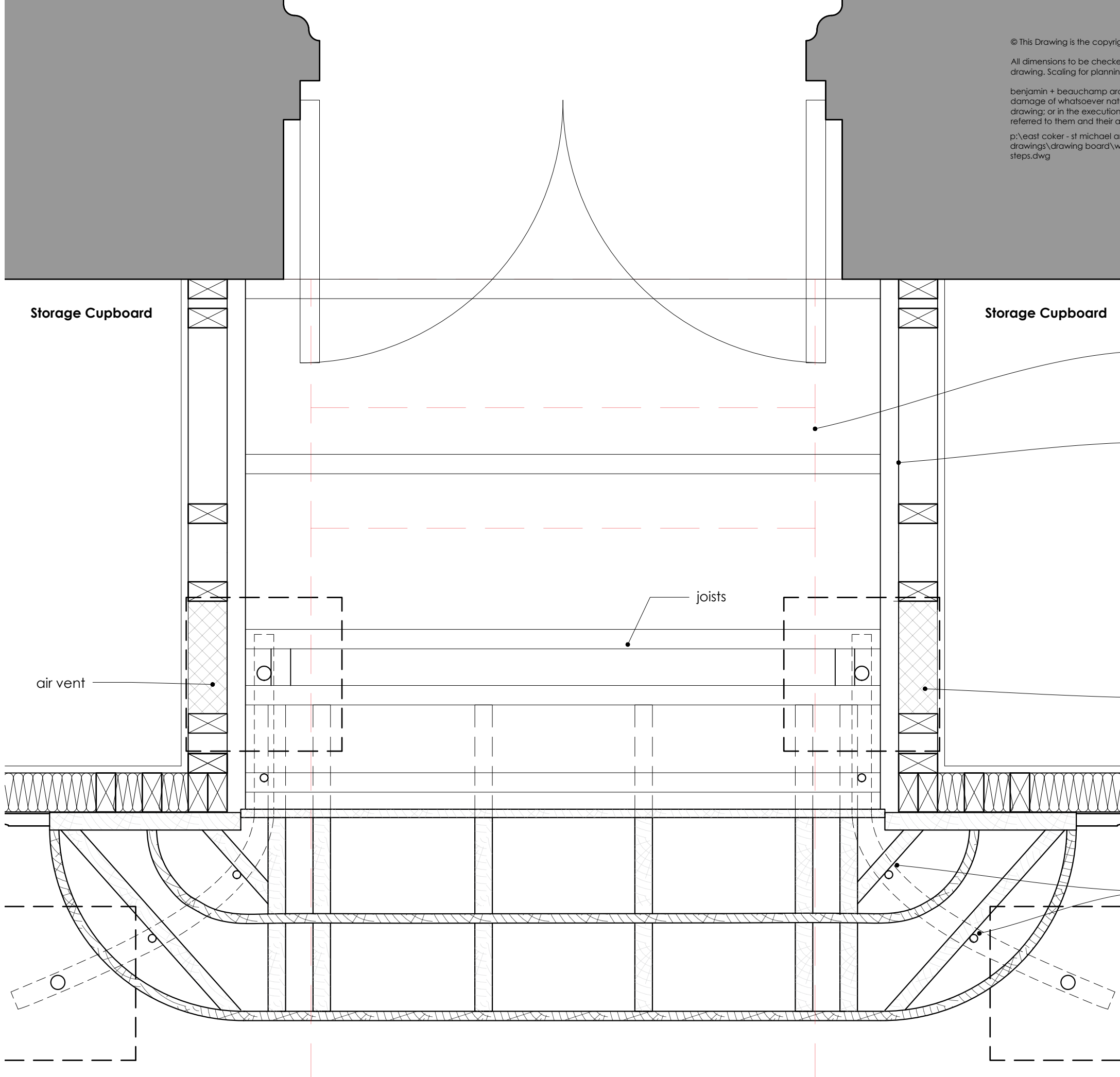

W End Steps - Joists Plan1:10@A1

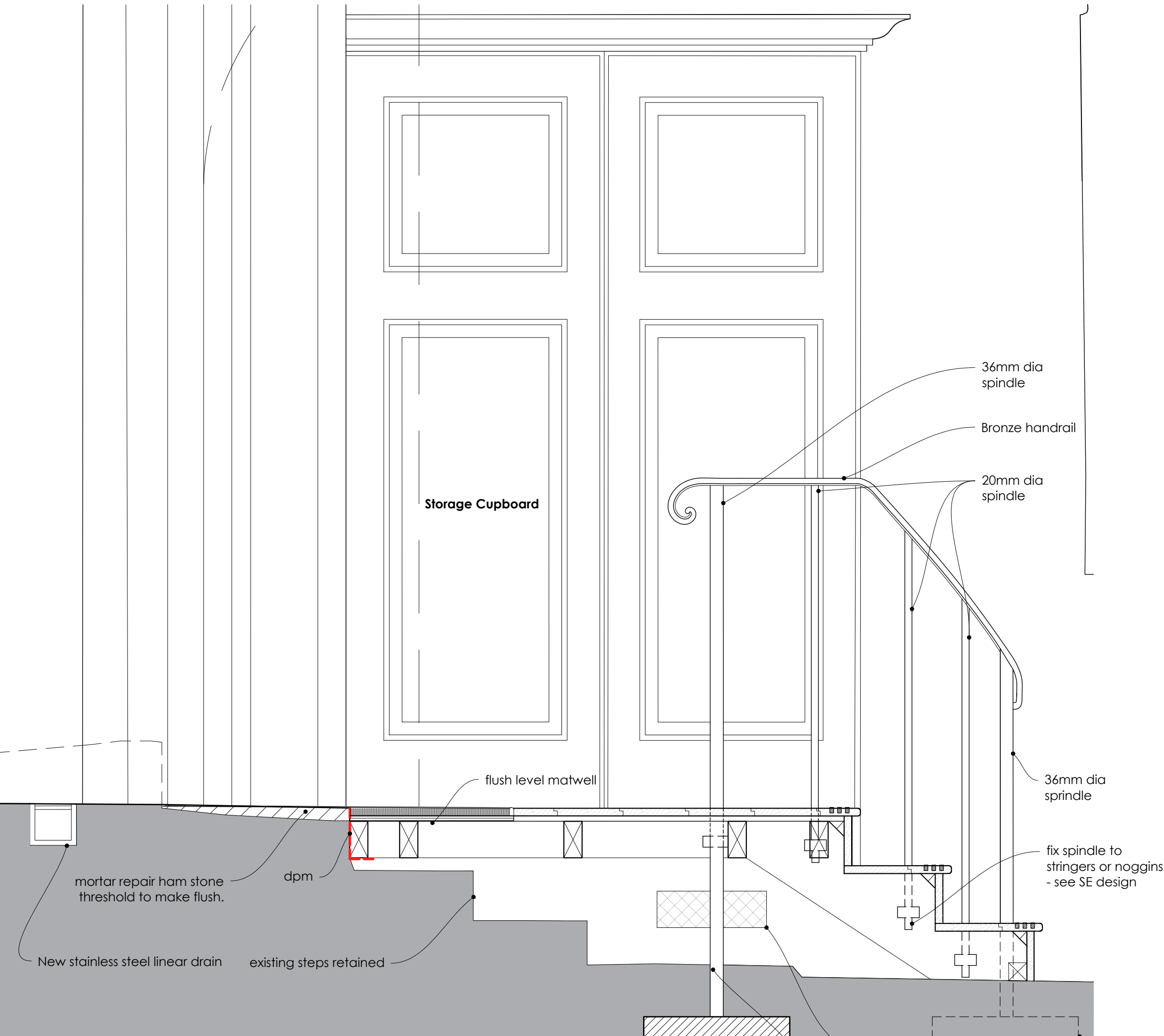

W End Steps - Section 1:10@A1



W End Steps - Elevation 1:10@A1

© This Drawing is the copyright of benjamin + beauchamp architects ltd.  
All dimensions to be checked on site by contractor and not scaled from this drawing. Scaling for planning purposes only.  
benjamin + beauchamp architects ltd accept no liability for any expense, loss or damage of whatsoever nature and however arising, from any variation made to this drawing or in the execution of the work to which it relates, which has not been referred to them and their approval obtained.  
p:\east coker - st michael and all angels - 0659\drawings, photos & graphics\b2 drawings\drawing board\working drawings\0659-wd.033 proposed west end steps.dwg

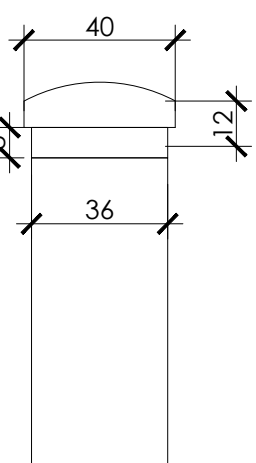

Bronze Handrail Detail 1:2@A1

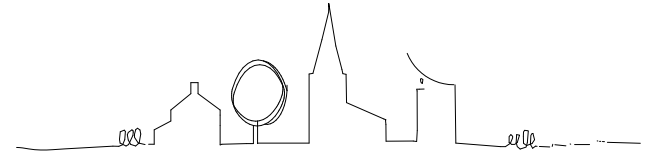
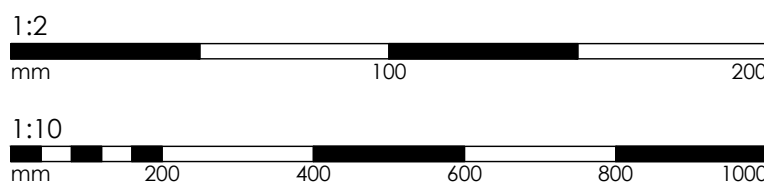

Revision Project Initials Notes

EAST COKER -  
St Michael and All Angels

Title

Proposed West End  
Staircase Joinery

Stage  
WORKING DRAWINGS

**b<sup>2</sup>** benjamin + beauchamp  
architecture design conservation  
the borough studios, the borough,  
wedmore, somerset BS28 4EB  
T 01934 713313 F 01934 713314

Drawn By IG Date 09.02.25 Scale 1:10/ 1:2 at A1

Drawing No 0659WD.033

Photos: b2architects.com www.b2architects.com



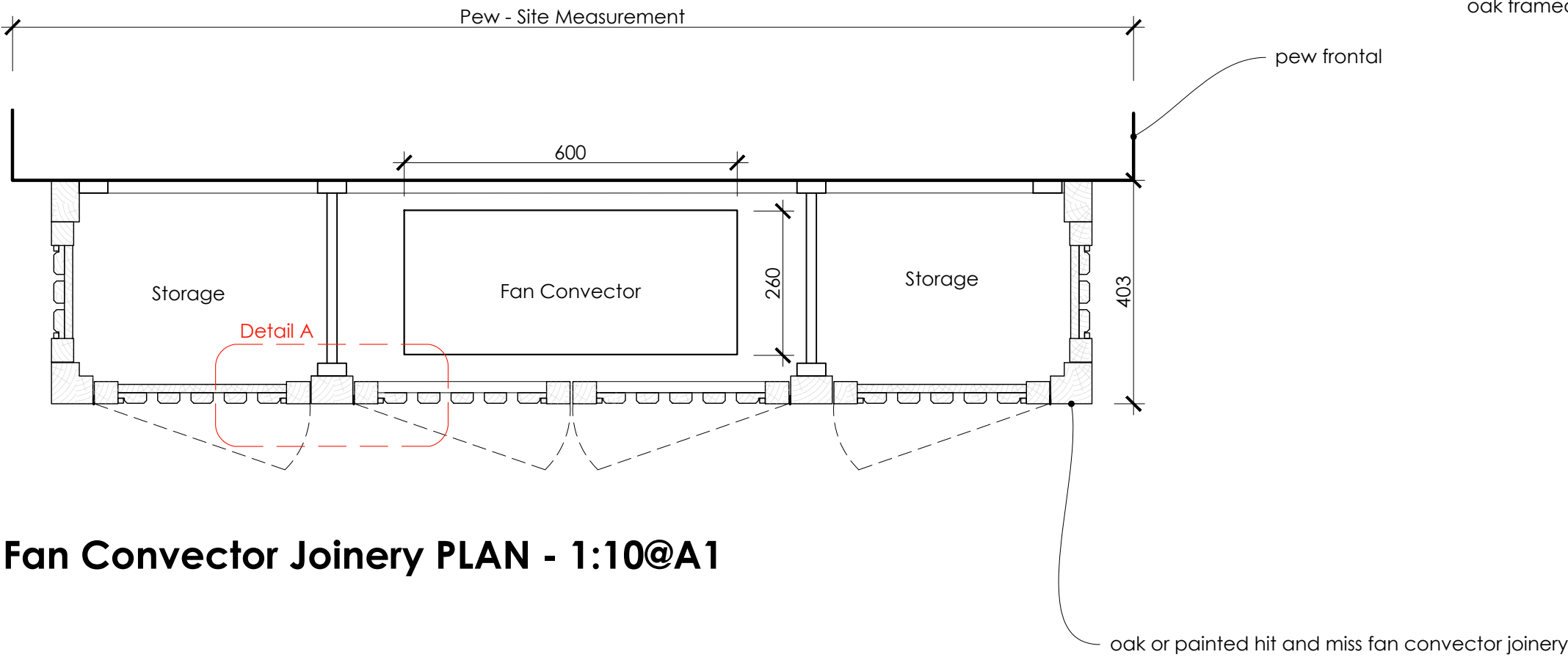

Fan Convector Joinery PLAN - 1:10@A1

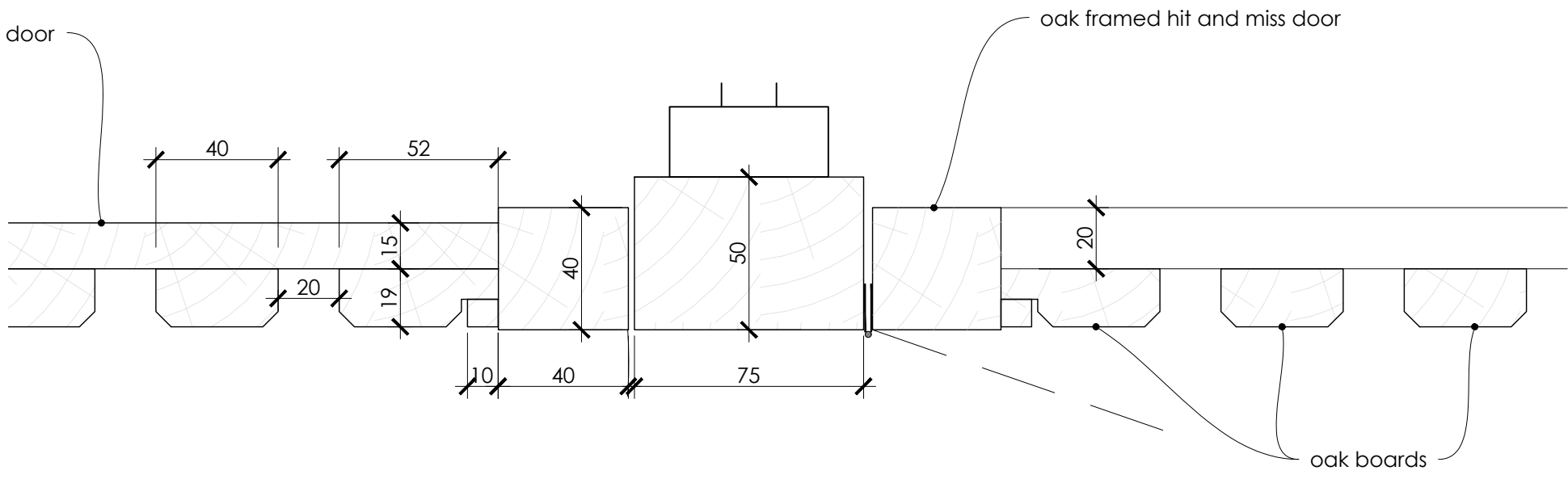

Detail A: Fan Convector Joinery DETAILS PLAN - 1:10@A1

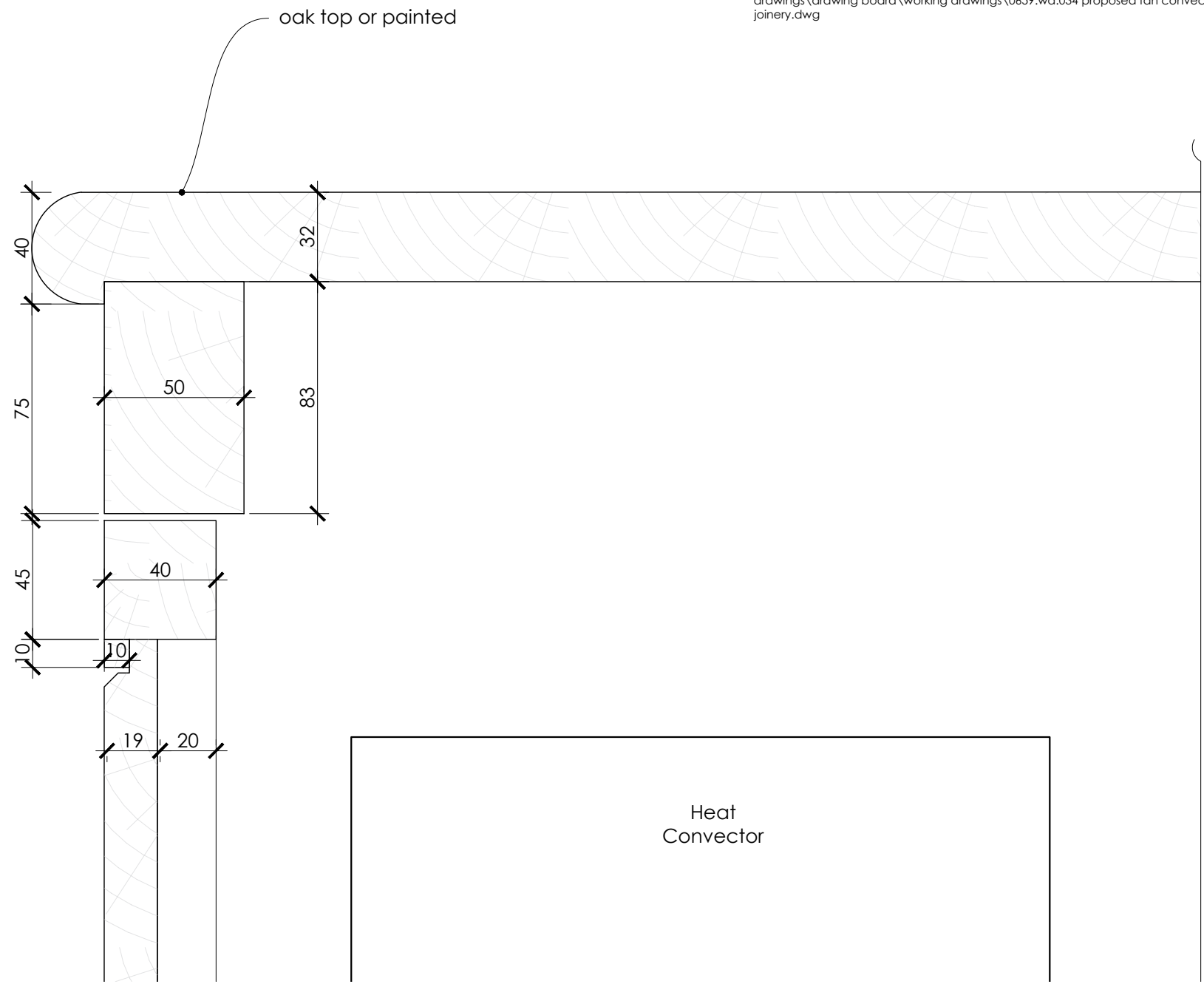

Fan Convector Joinery DETAILS SECTION - 1:10@A1

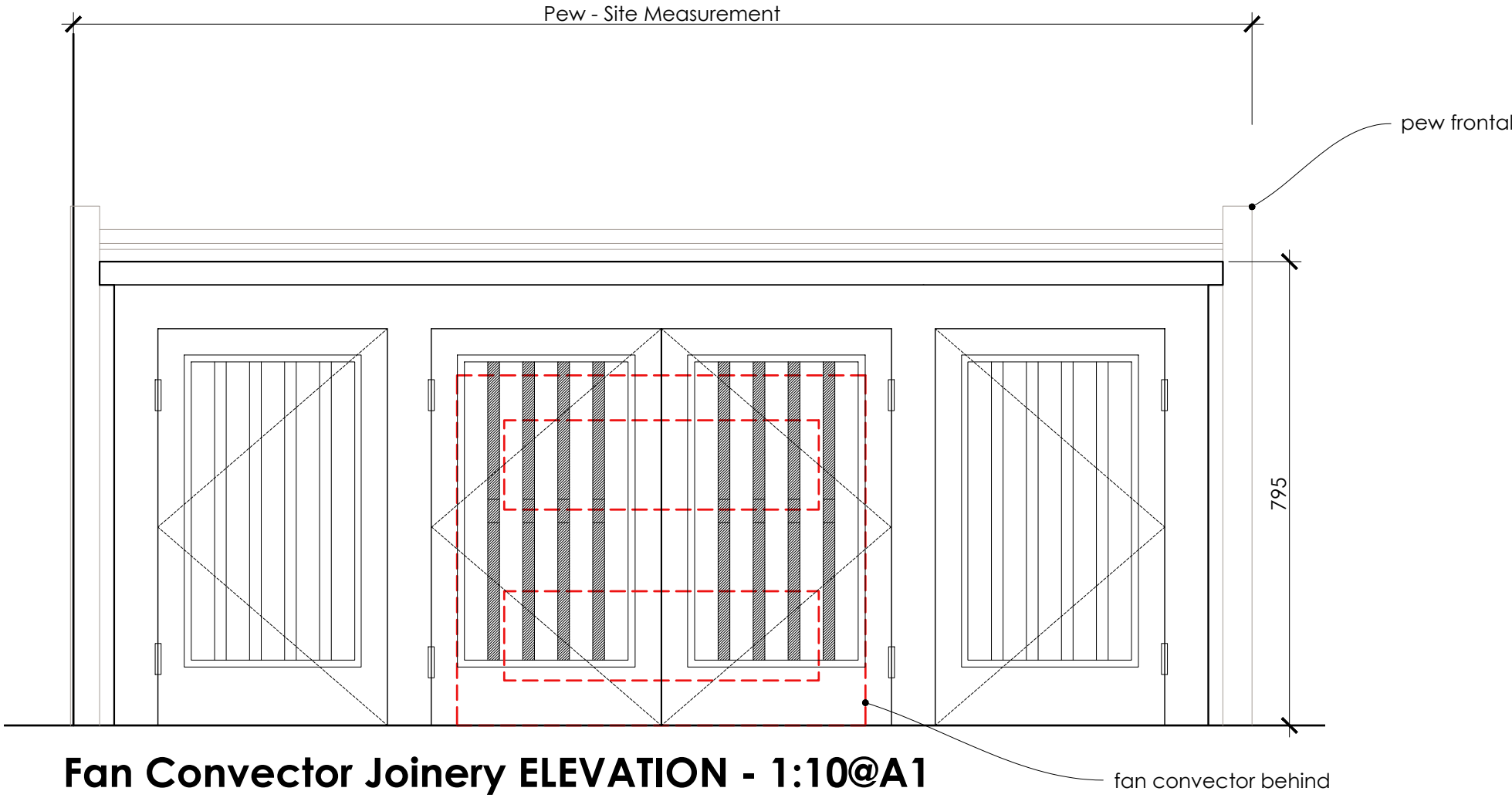

Fan Convector Joinery ELEVATION - 1:10@A1

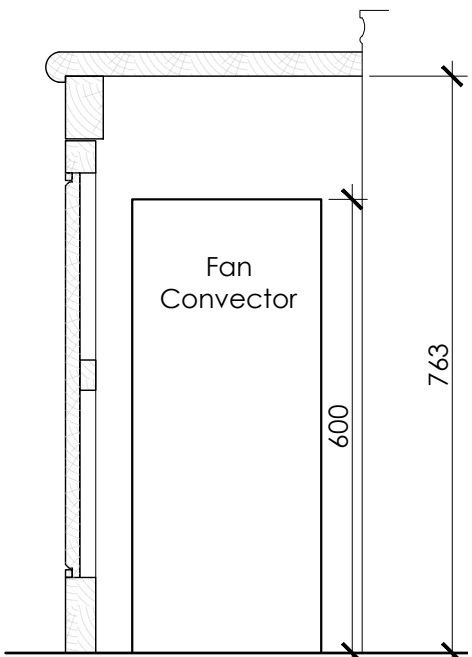

Heat Convector Joinery SECTION- 1:10@A1

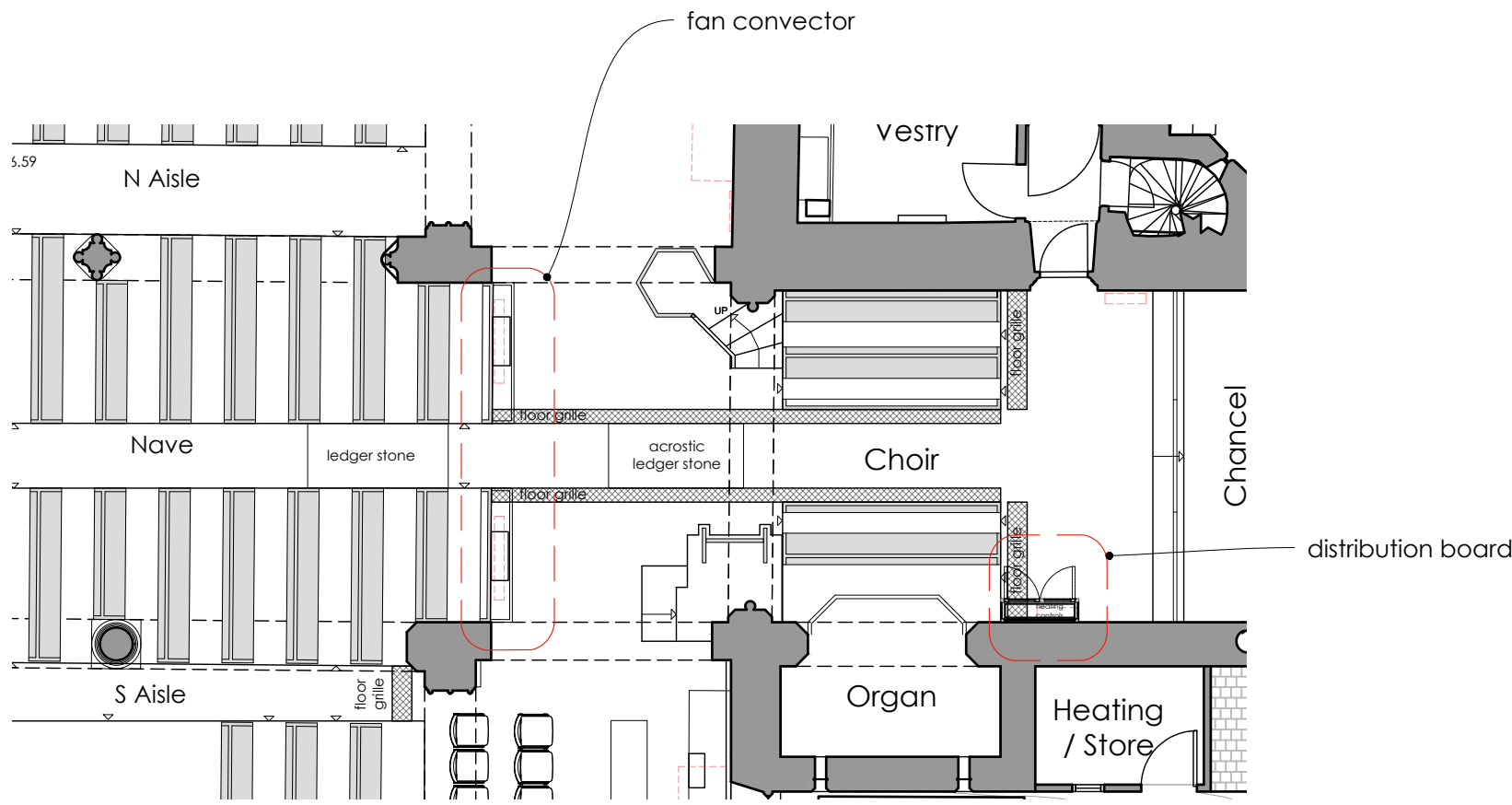

KEY PLAN- 1:100@A1

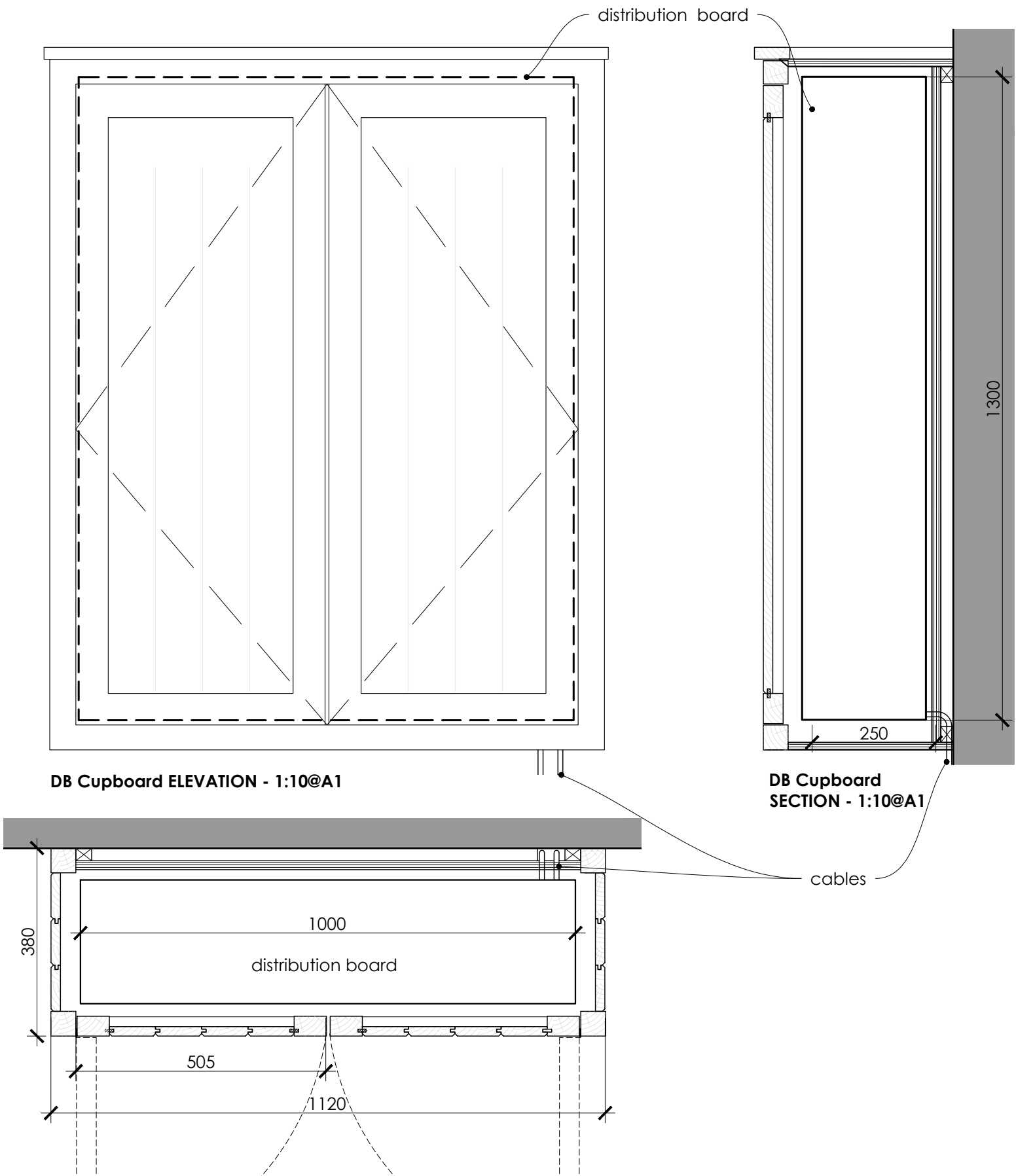

DB Cupboard ELEVATION - 1:10@A1

DB Cupboard SECTION - 1:10@A1

DB Cupboard PLAN - 1:10@A1

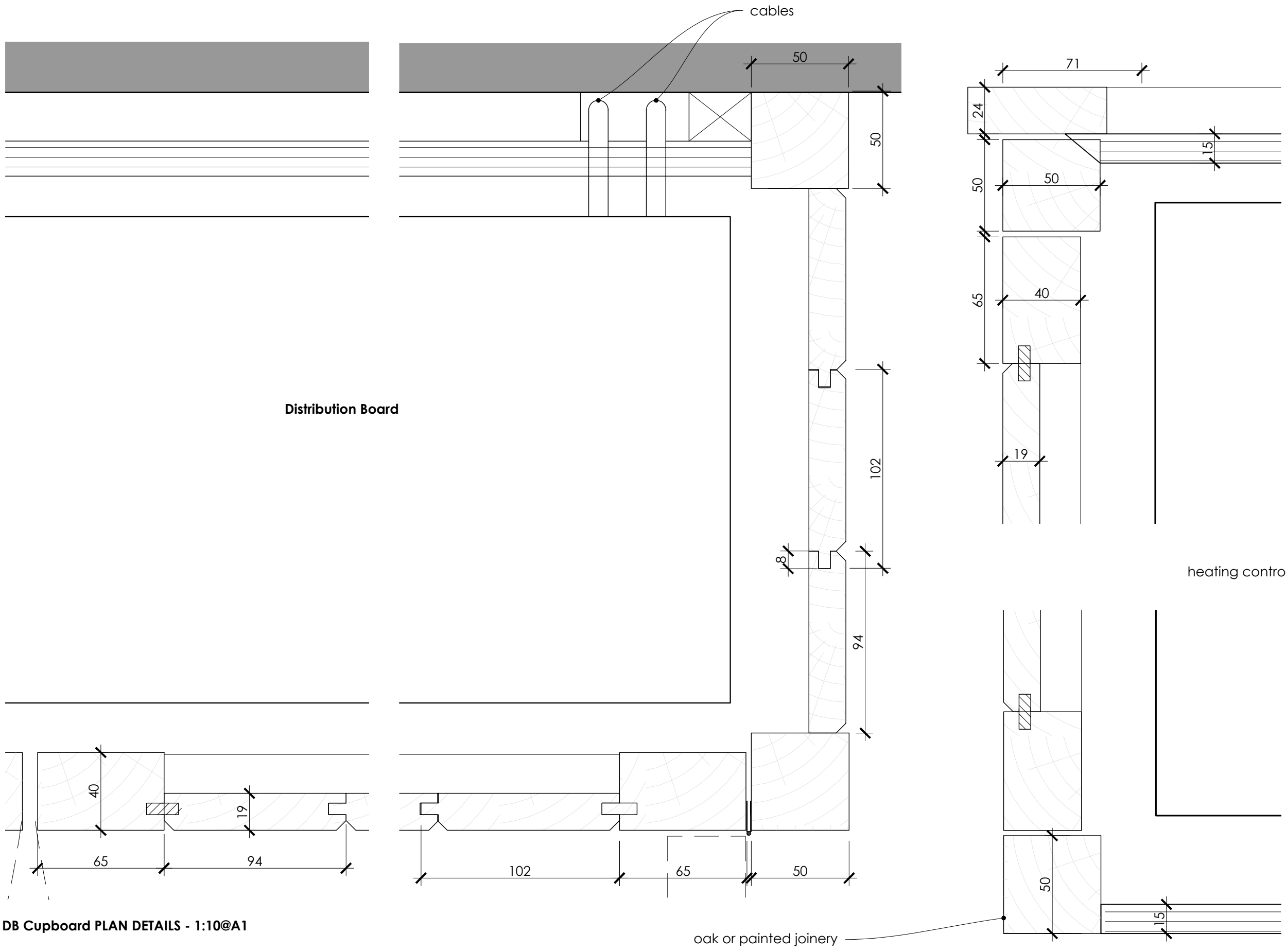

DB Cupboard PLAN DETAILS - 1:10@A1

DB Cupboard SECTION DETAILS - 1:10@A1

