

PLAN 1:20

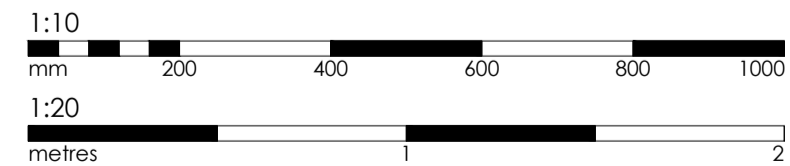

benjamin + beauchamp
architecture design conservation
the borough studios, the borough,
wedmore, somerset BS28 4EB
T 01934 713313 F 01934 713314

SECTION THROUGH OPEN EDGE 1:10

Fix handrail post down centrally through 150mm grey lias walling stone and fix to base plate on footing to engineer's details.

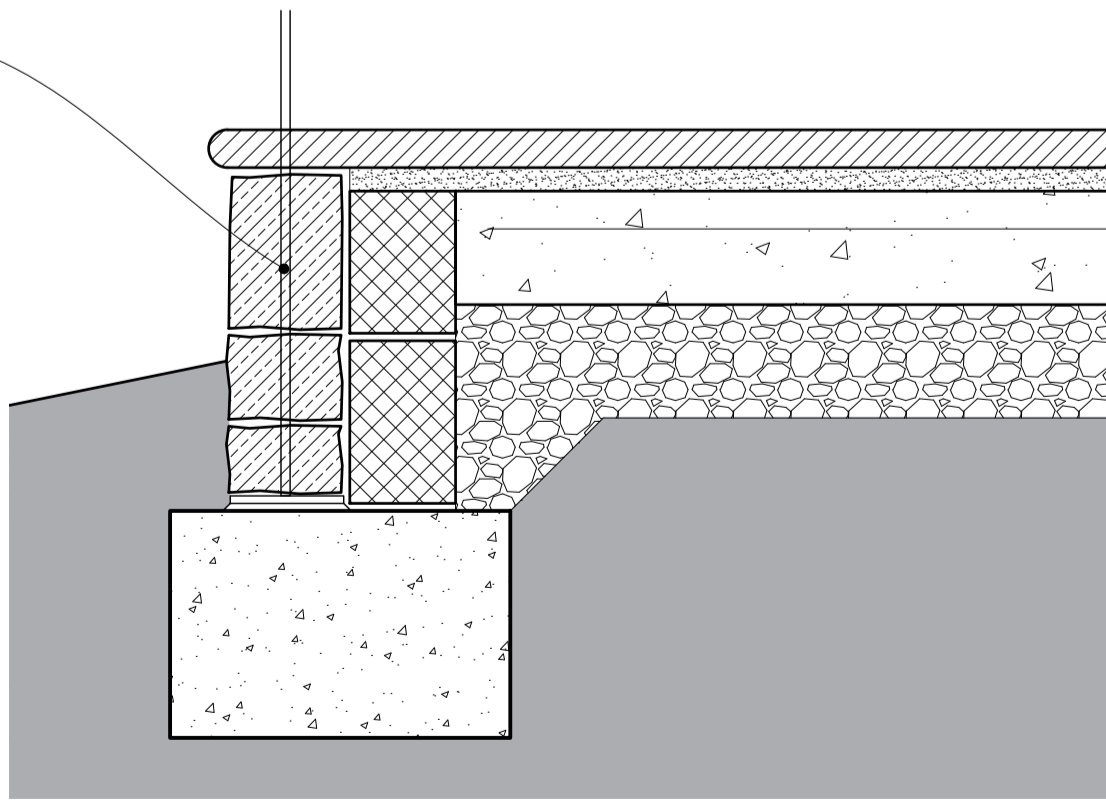

Mild steel convex bar with square edges handrail 38x12mm with scroll ends. Welded Mild steel 12x12mm spindles, at regular centres. All galvanised and painted black. Set spindles 175mm into stone and fix with hot lead method for kerb. Fix into concrete base at edge.

3no. 12x5mm stainless steel nosing inserts spaced at 25mm centres to each step.

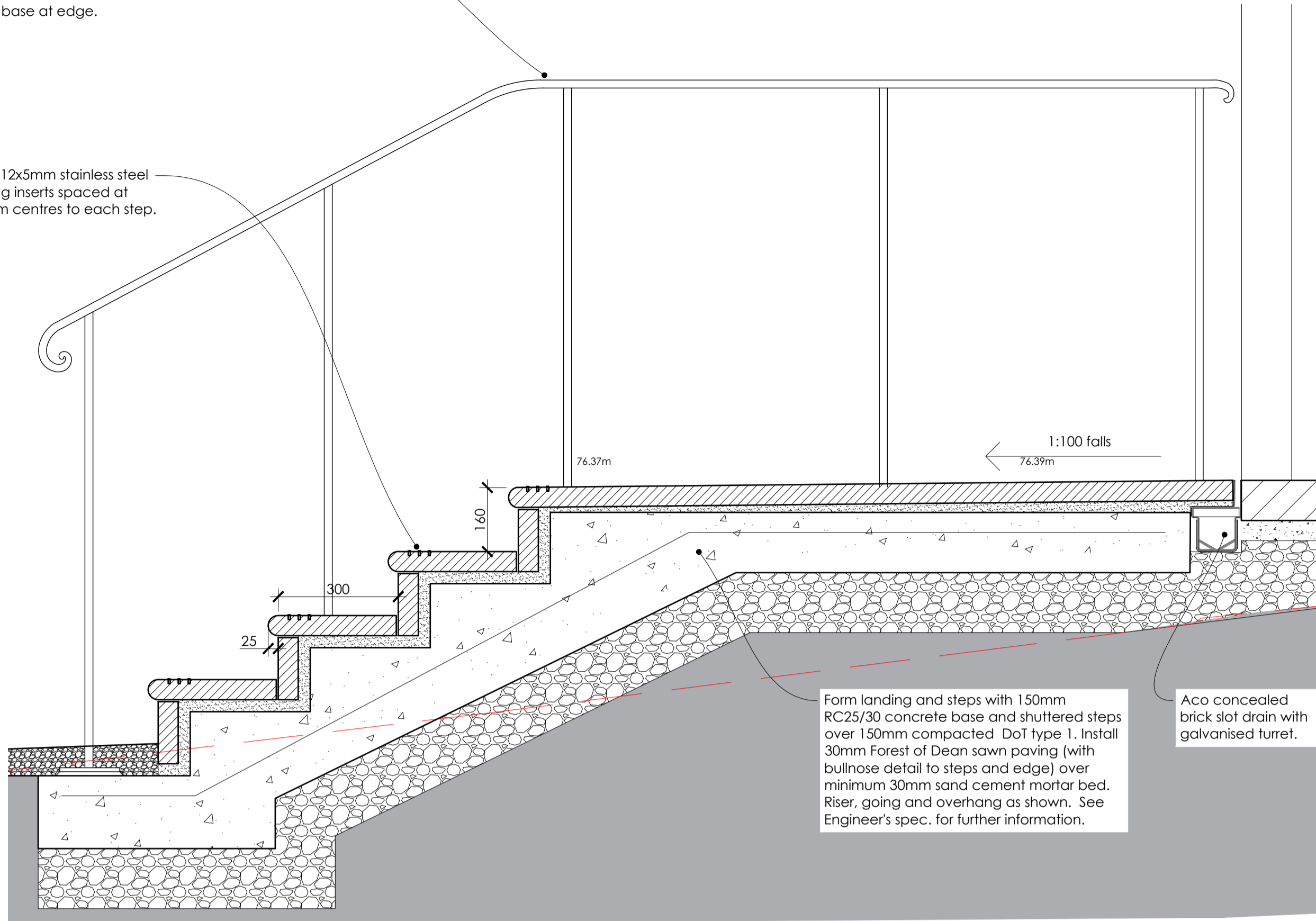

SECTION THROUGH STEPS 1:10

Form raised bed against retaining wall with 50mm sawn doulling stone edge set in lean mix concrete haunch. Fill with minimum 150mm topsoil over loose pea gravel drainage and 100mm compacted DoT type 1 base.

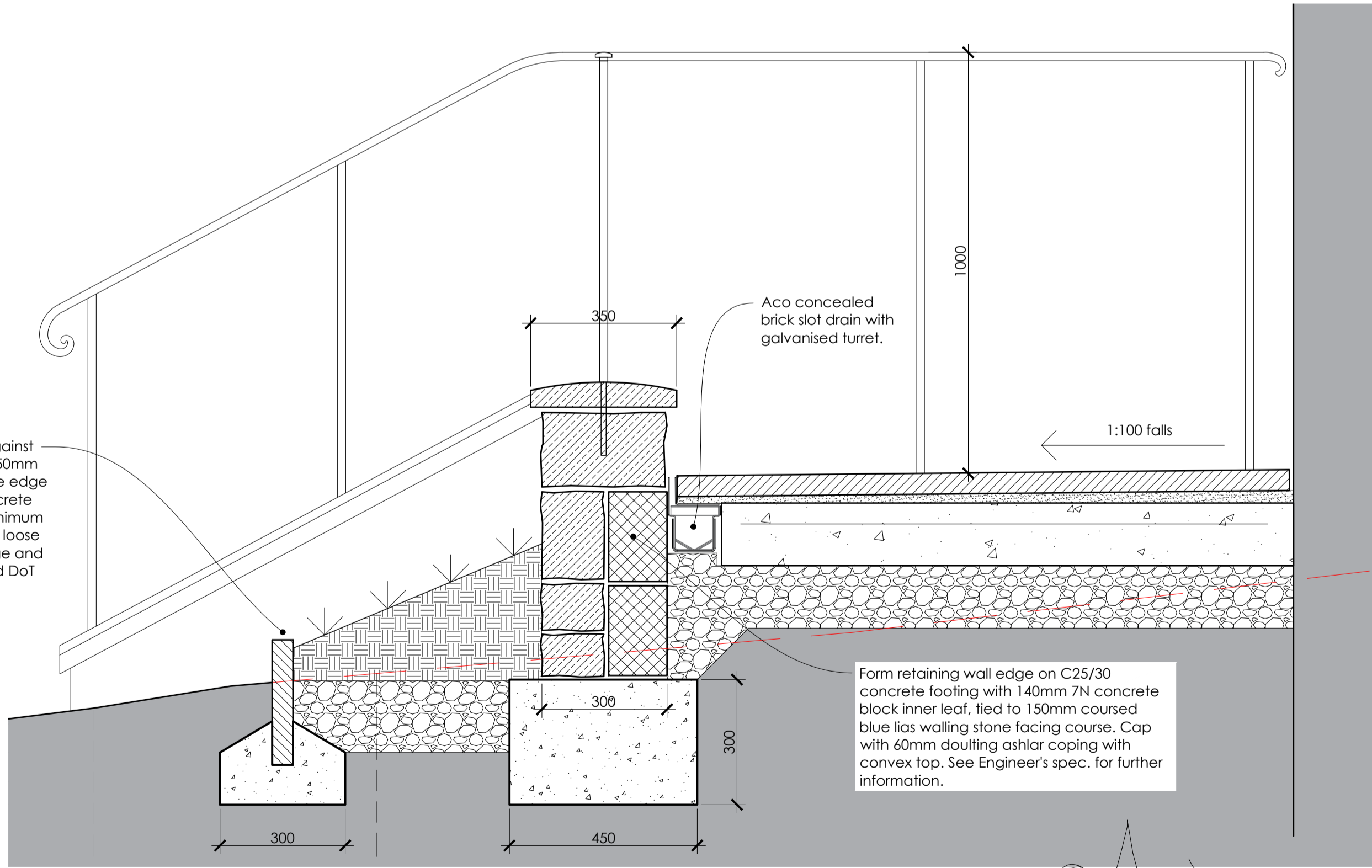

SECTION THROUGH RETAINING EDGE 1:10

Project
EAST COKER St Michael and All Angels

Title
North Porch and External Dais Steps

Working Drawing

Drawn by	Date	Scale
mh	24.09.25	varies at A1

Revision	Date	Initials	Notes
A	07.10.25	mh	Notes revised.

Drawing No.

0659.WD.020 A

studio@b2architects.com www.b2architects.com

F:\East Coker - St Michael and All Angels - 0659\Drawings, Photos & Graphics\B2 Drawings\Drawing board\WORKING DRAWINGS\0659.WD.020 North Porch and External Dais Steps.dwg

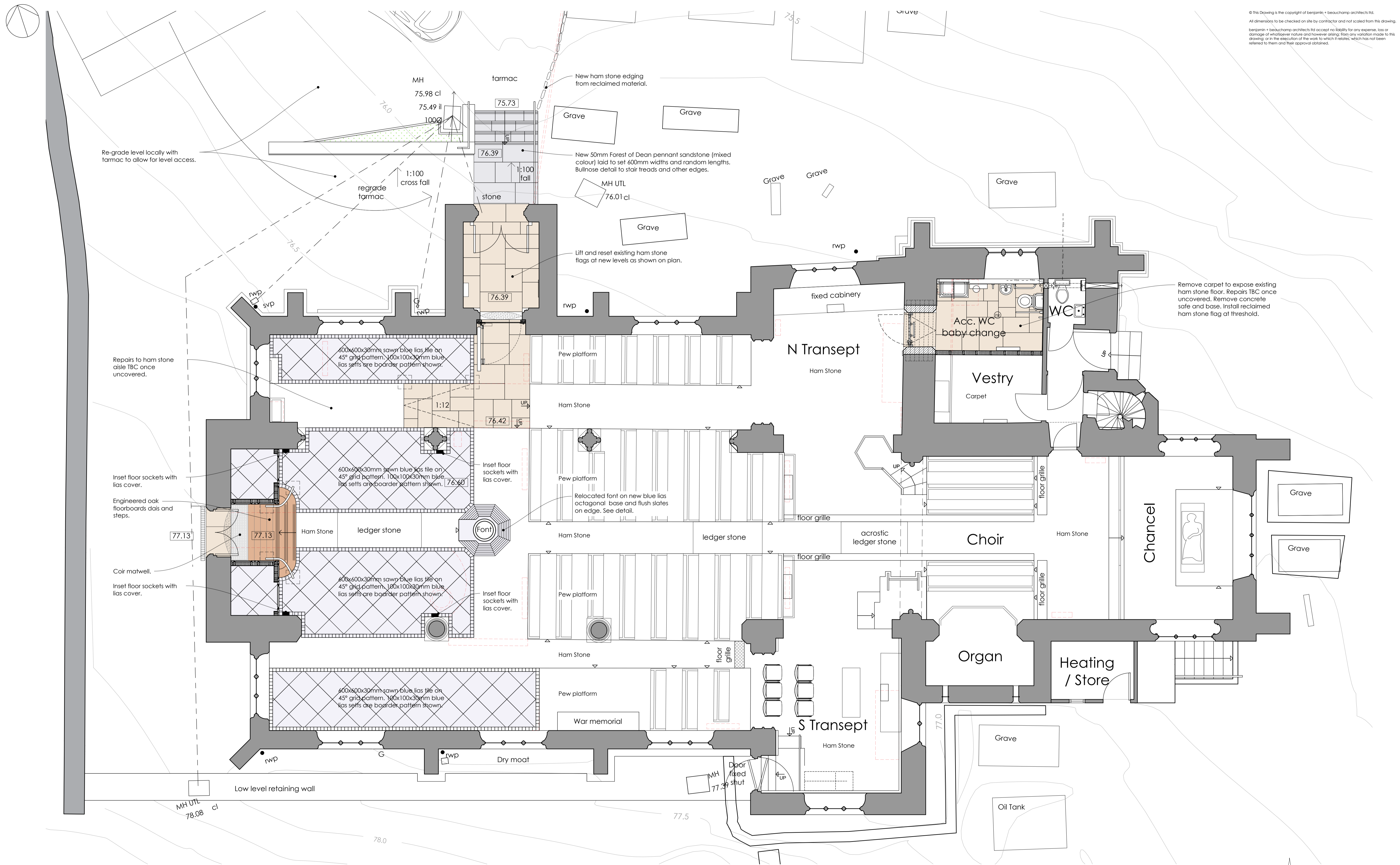

1:50
metres

benjamin + beauchamp
architecture design conservation
the borough studios, the borough,
wedmore, somerset BS28 4EB
T 01934 713313 F 01934 713314

Project
EAST COKER St Michael and All Angels

Title
Floor Finishes Plan

Stage
WORKING DRAWING

Drawn by	Date	Scale
mh	15.08.25	1:50 at A1

Revision	Date	Initials	Notes
A	07.10.25	mh	Plan updated.

Drawing No.

0659.WD.021 A

studio@b2architects.com www.b2architects.com

F:\East Coker - St Michael and All Angels - 0659 Drawings, Photos & Graphics\B2 Drawings\Drawing boards\WORKING DRAWINGS\0659.WD.021 Floor Finishes Plan.dwg



Photograph of existing font to be relocated.
Remove existing stepped plinth.

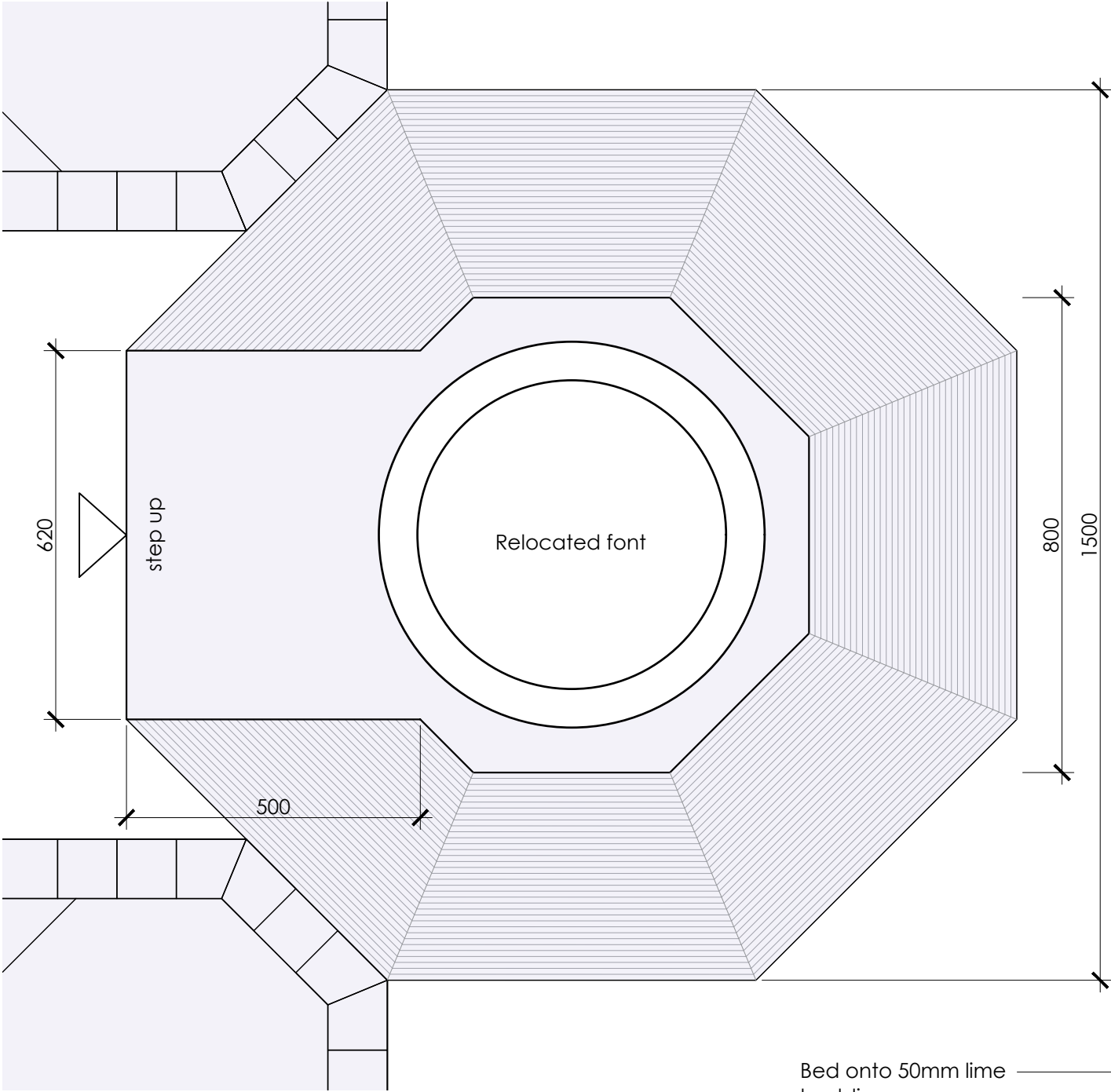

Proposed Plan
1:10

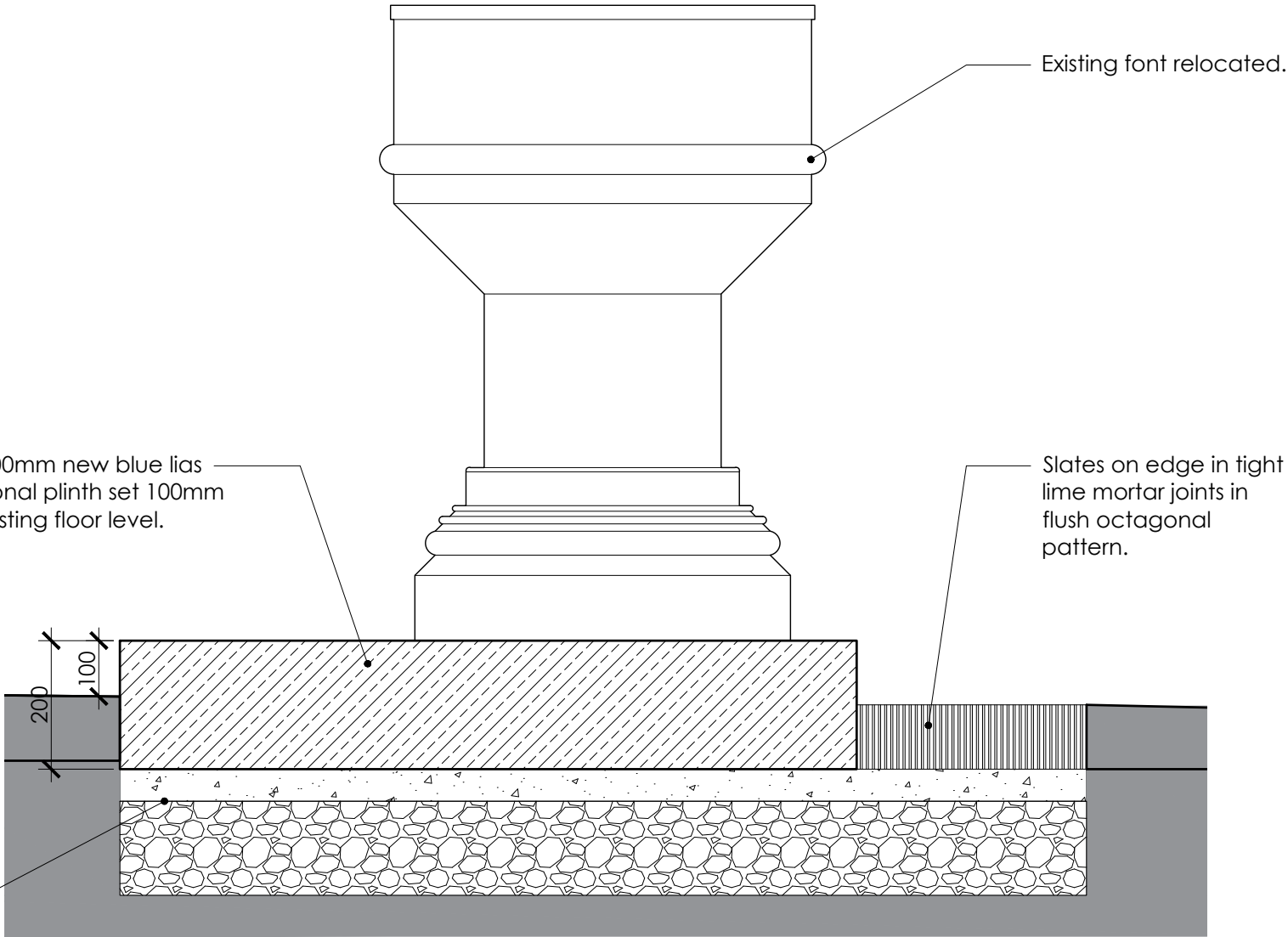

Proposed Elevation (shown from north aisle)
1:10

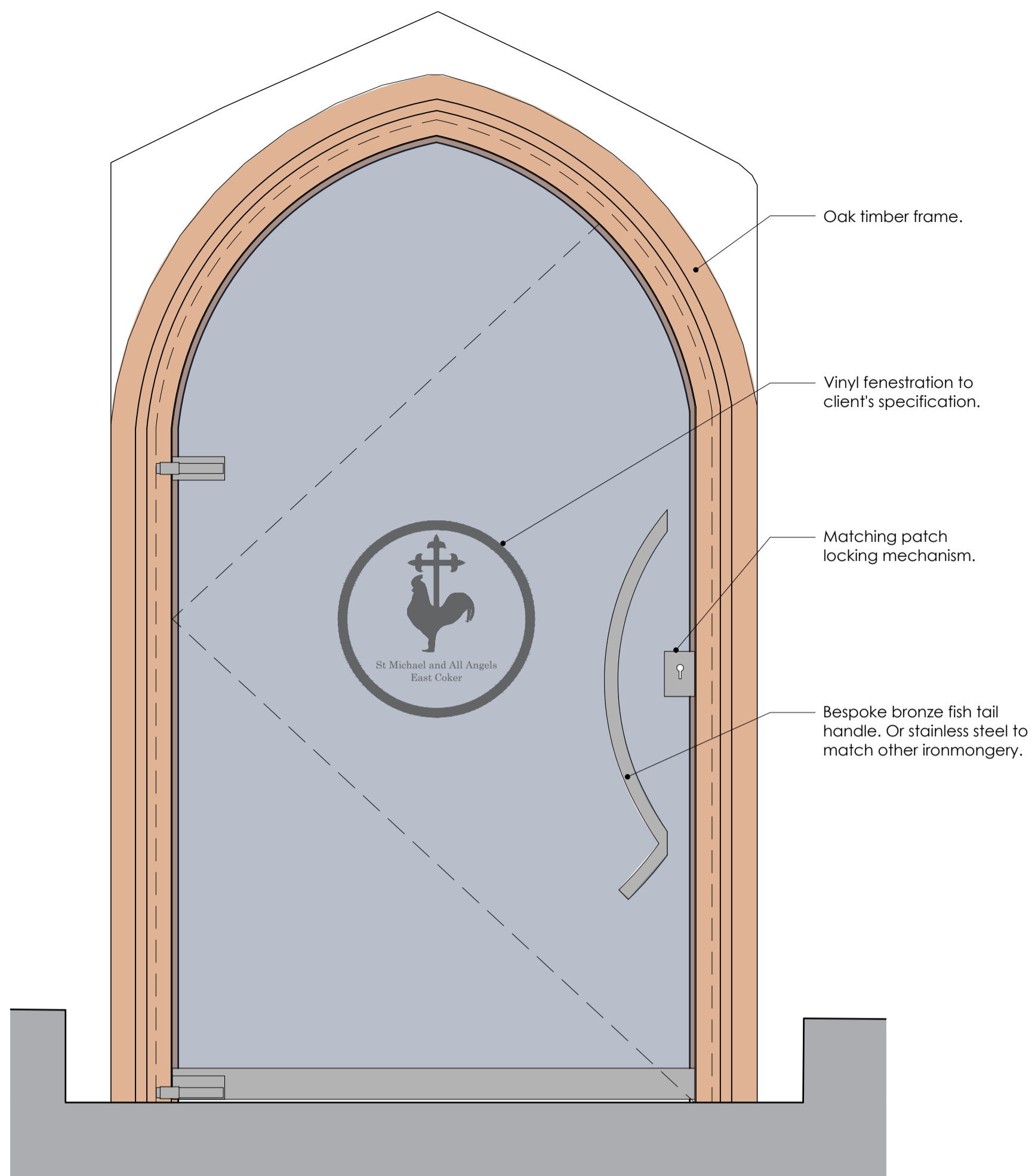
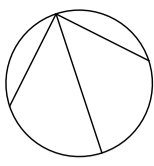

Proposed Elevation (shown from north aisle)
1:10



Photograph of existing north door arrangement.

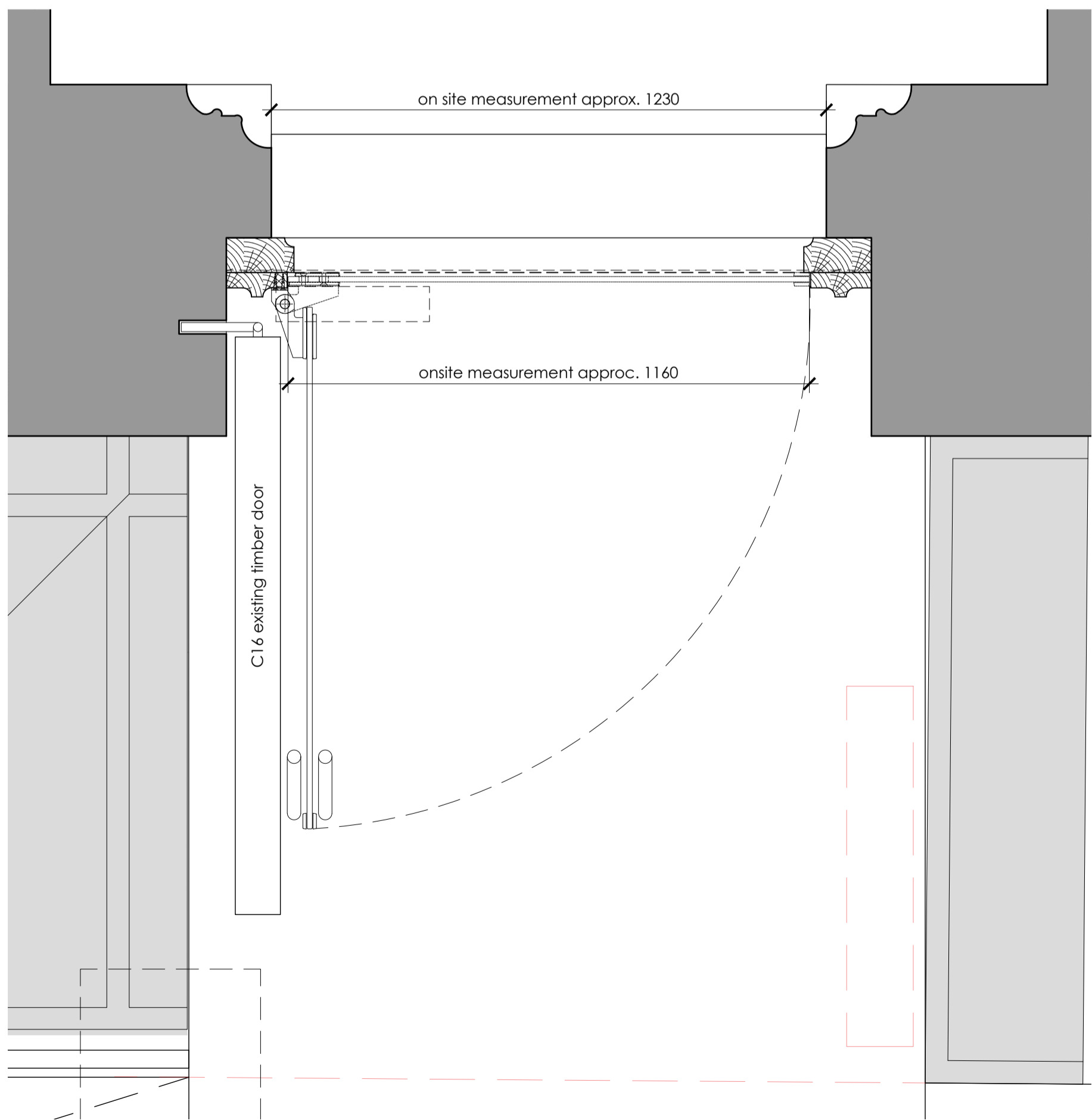

Proposed Plan
1:10

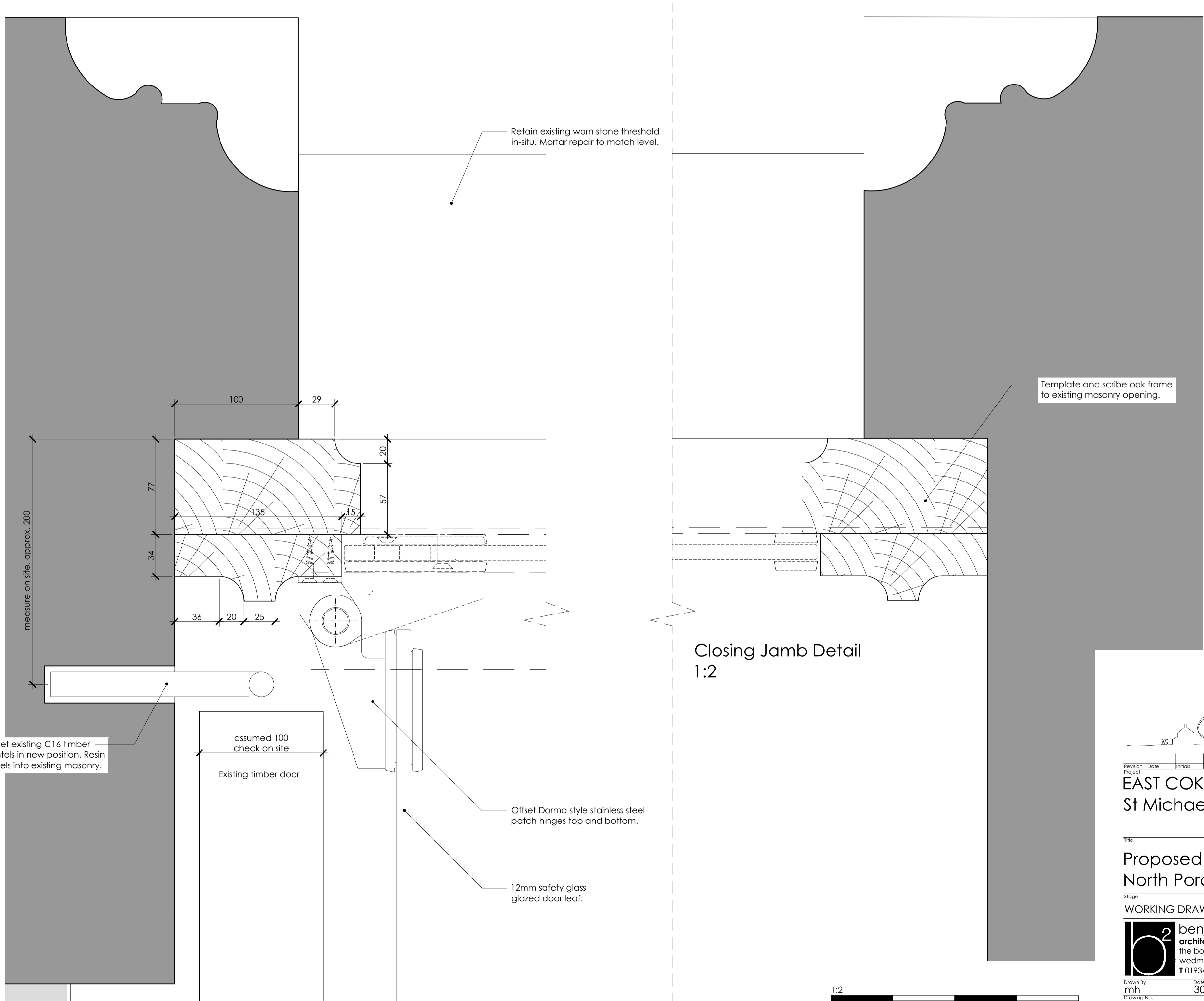

Hinged Jamb Detail
1:2

Closing Jamb Detail
1:2

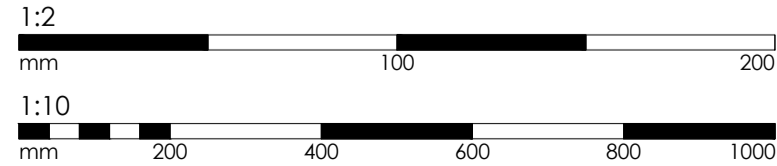

© This Drawing is the copyright of benjamin + beauchamp architects ltd.
All dimensions to be checked on site by contractor and not scaled from this drawing.
benjamin + beauchamp architects ltd accept no liability for any expense, loss or damage of whatsoever nature and however arising from any variation made to this drawing or in the execution of the work to which it relates, which has not been referred to them and their approval obtained.
p:\east coker - st michael and all angels - 0659\drawings, photos & graphics\02 drawings\drawing board\working drawings\0659-wd.023 new glazed north porch door.dwg

Revision Date Initials Notes

EAST COKER
St Michael and All Angels

Title

Proposed New Glazed North Porch Door

Stage
WORKING DRAWINGS

benjamin + beauchamp
architecture design conservation
the borough studios, the borough,
wedmore, somerset BS28 4EB
T 01934 713313 F 01934 713314

Drawn By
mh
Date
30.09.25
Scale
varies at A1

Drawing No.
0659 WD.023
A

studio + 02040404040 www.b2architects.com

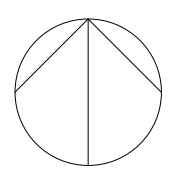
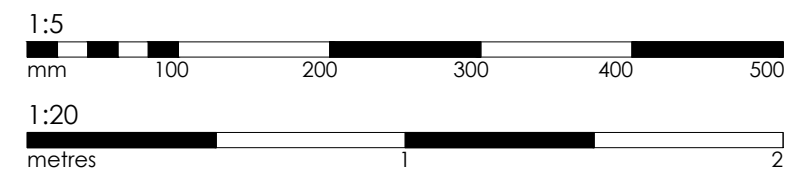

© This Drawing is the copyright of benjamin + beauchamp architects ltd.
All dimensions to be checked on site by contractor and not scaled from this drawing. Scaling for planning purposes only.
benjamin + beauchamp architects ltd accept no liability for any expense, loss or damage of whatsoever nature and however arising; from any variation made to this drawing; or in the execution of the work to which it relates, which has not been referred to them and their approval obtained.
p:\east coker - st michael and all angels - 0659\drawings, photos & graphics\bd drawings\drawing board\working drawings\0659.wd.024 proposed ramp.dwg

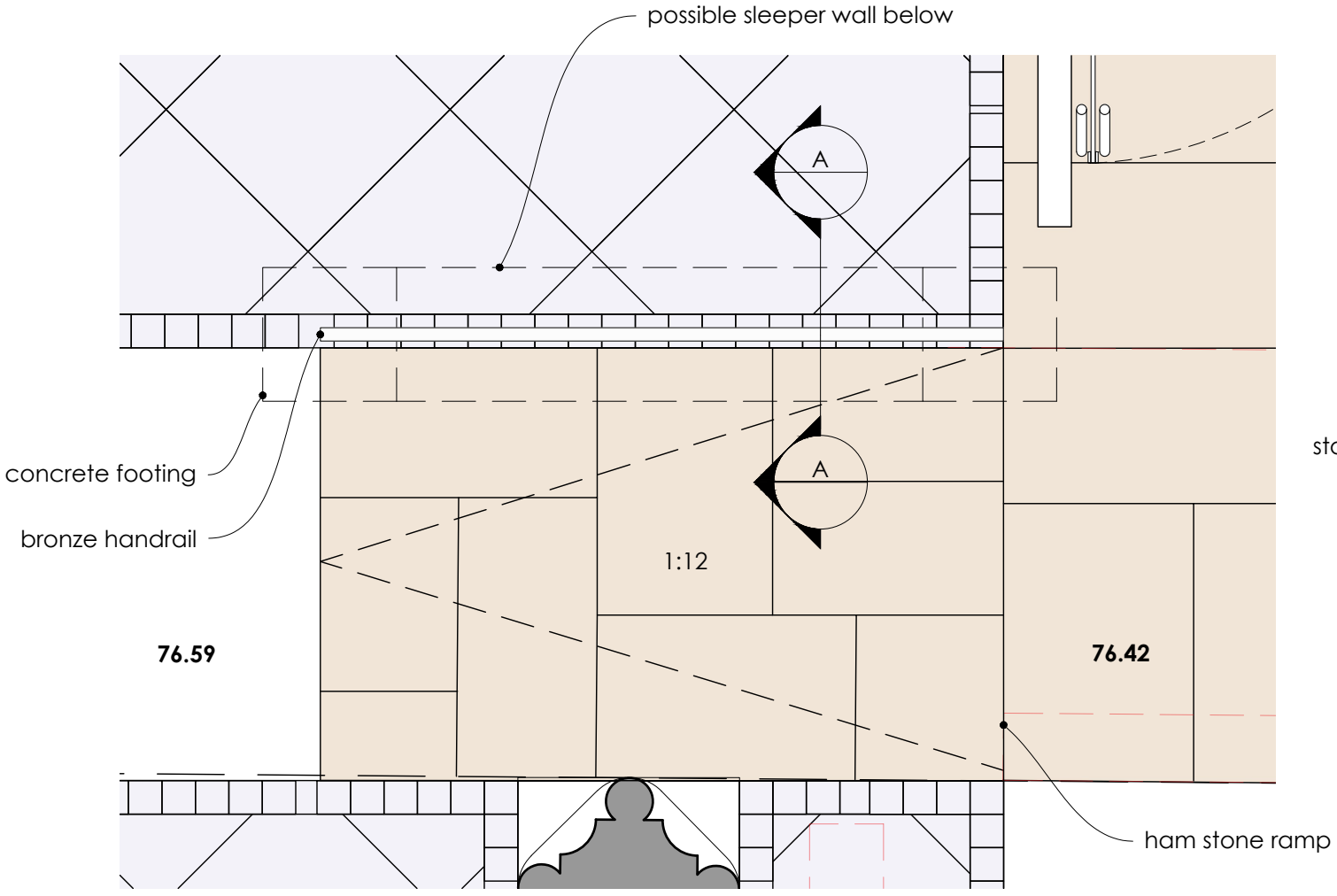

Proposed Ramp Plan - 1:20@A1

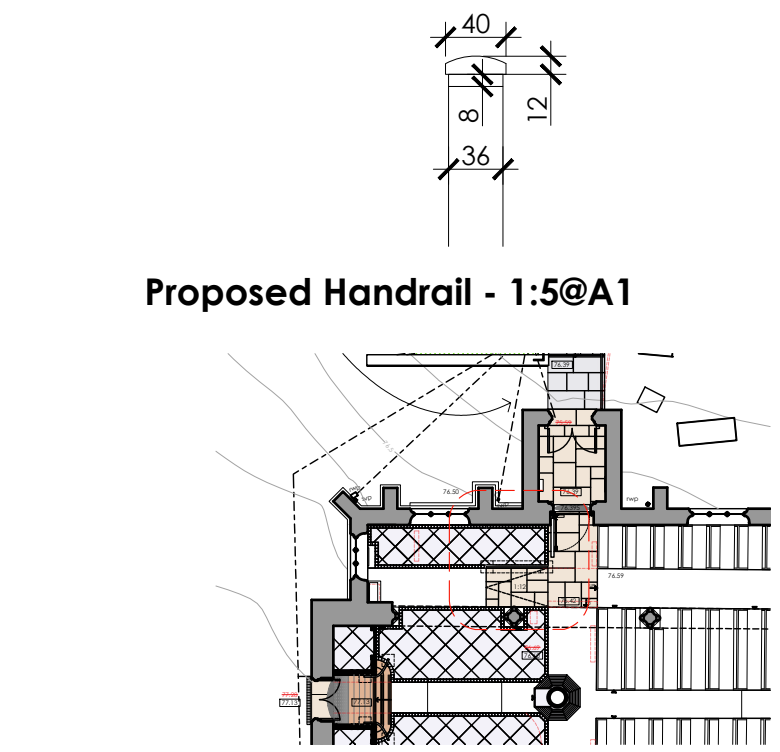

Proposed Handrail - 1:5@A1

Key Plan- 1:250@A1

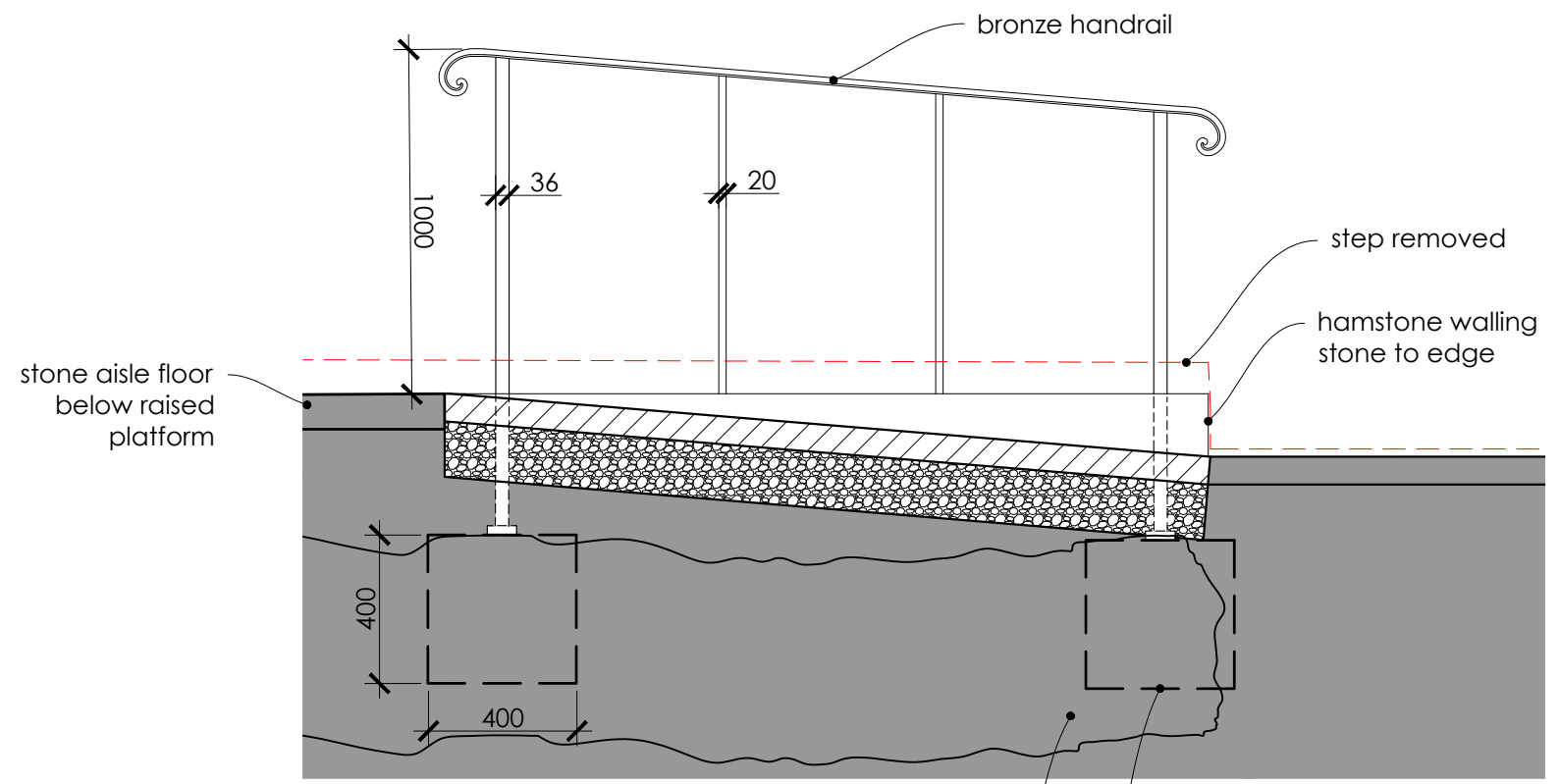

Proposed Ramp Section- 1:20@A1

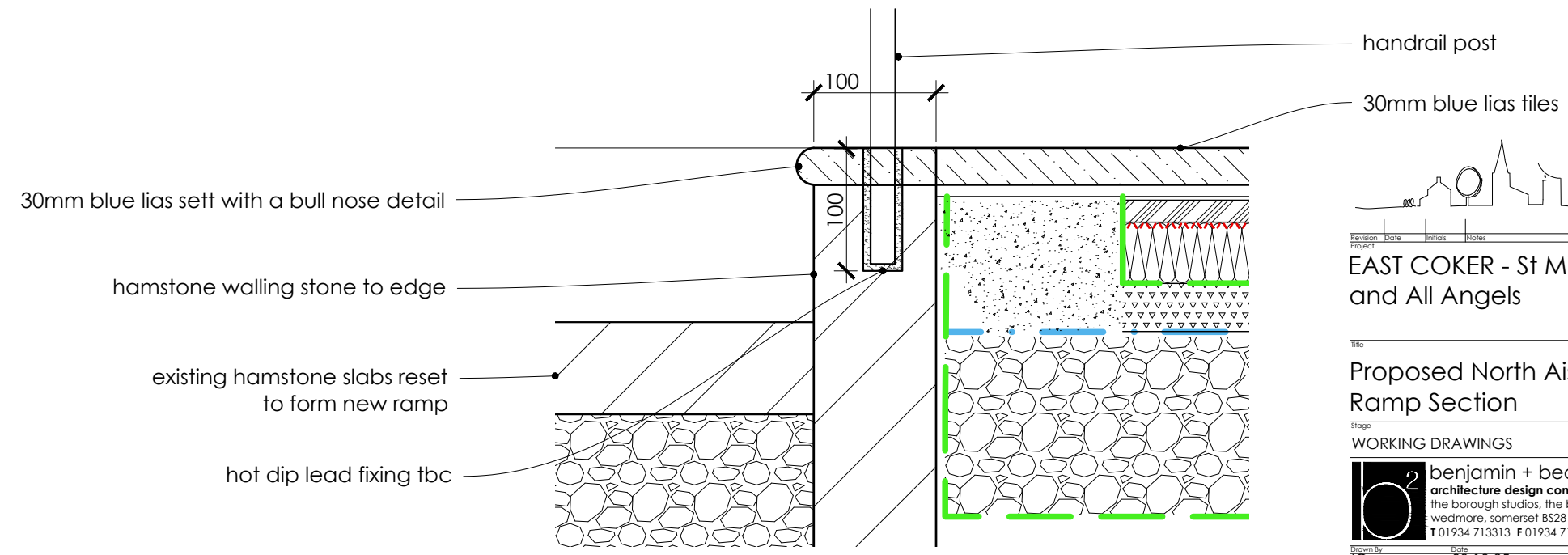

Proposed Ramp floor detail- 1:5@A1

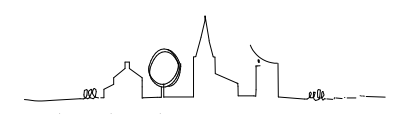

Revision	Date	Initials	Notes

EAST COKER - St Michael and All Angels

Title

Proposed North Aisle Ramp Section

Stage

WORKING DRAWINGS

benjamin + beauchamp
architecture design conservation
the borough studios, the borough,
wedmore, somerset BS28 4EB
T 01934 713313 F 01934 713314

Drawn By	Date	Scale
IG	08.10.25	1:20/5 at A3

Drawing No: **0659 WD.024** **A**