

GROUND FLOOR PLAN

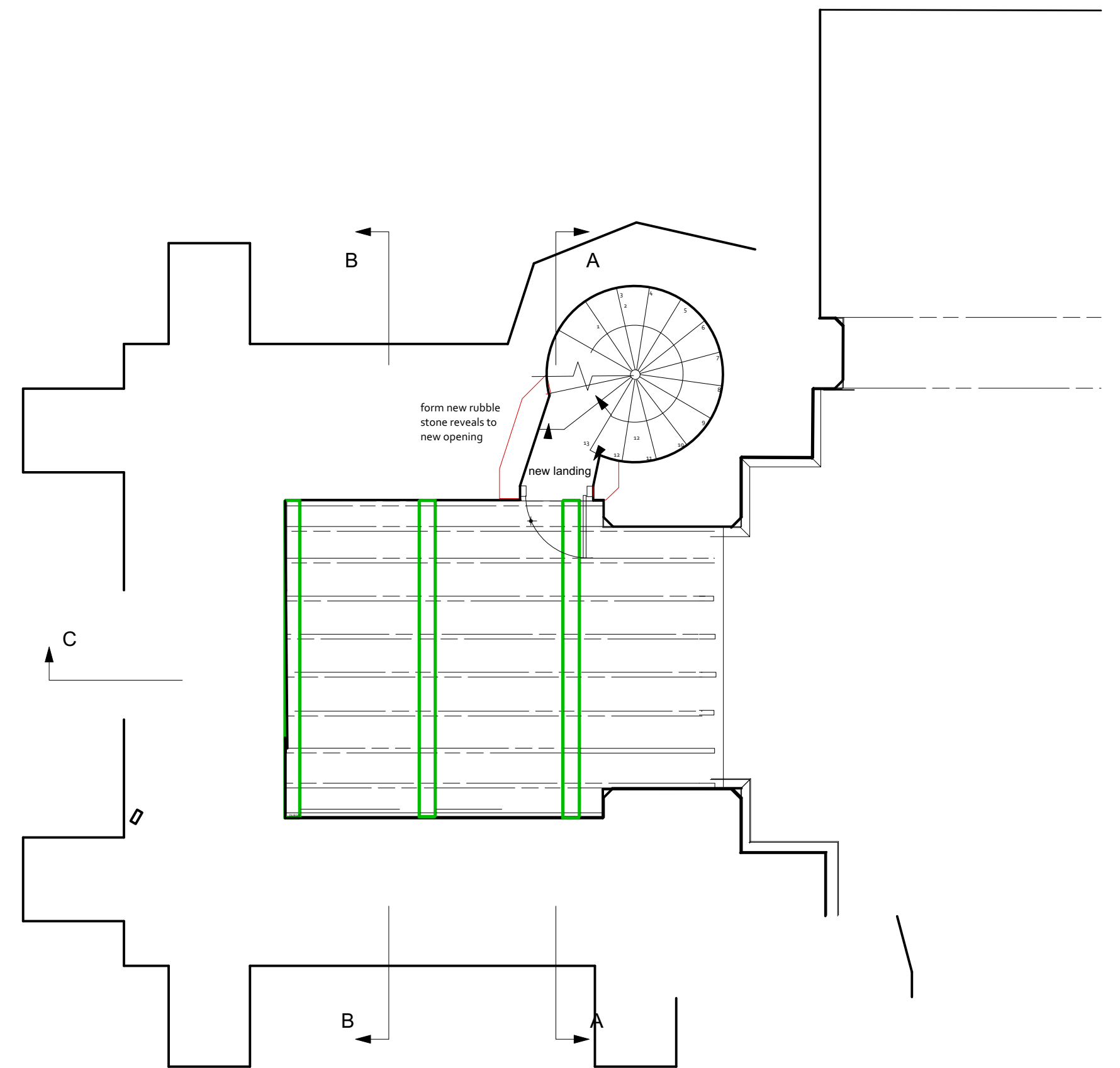

FIRST FLOOR PLAN



Annie Evans architect Sowdens
Fiddington
Bridgwater
TA5 1JH
tel 01278 732339
e-mail architecture@annie-evans.co.uk

Job NORTON FITZWARREN ALL SAINTS
Drawing Lavatory proposals Tower Option D
Number 237.06E
Scale 1:50 when printed at A2
Date March 2023
Revisions additional pews taken out dec23