

© This Drawing is the copyright of benjamin + beauchamp architects ltd.  
All dimensions to be checked on site by contractor and not scaled from this drawing.  
benjamin + beauchamp architects ltd accept no liability for any expense, loss or damage of whatsoever nature and however arising from any variation made to this drawing or in the execution of the work to which it relates, which has not been referred to them and their approval obtained.  
p:\glastonbury - st benedicts - 0875\drawings, photos & graphics\b2 drawings\drawing board\0875.p.006 proposed ground floor finishes floor plan.dwg

DRAFT

- Key
- Re-use stone Lias paving from existing central aisle
  - Blue Lias flagstones salvaged from underlying floor (North & South Aisles)
  - New Purbeck 'Jurassic blend' stone tiles
  - Re-used Ashlar Bath stone border

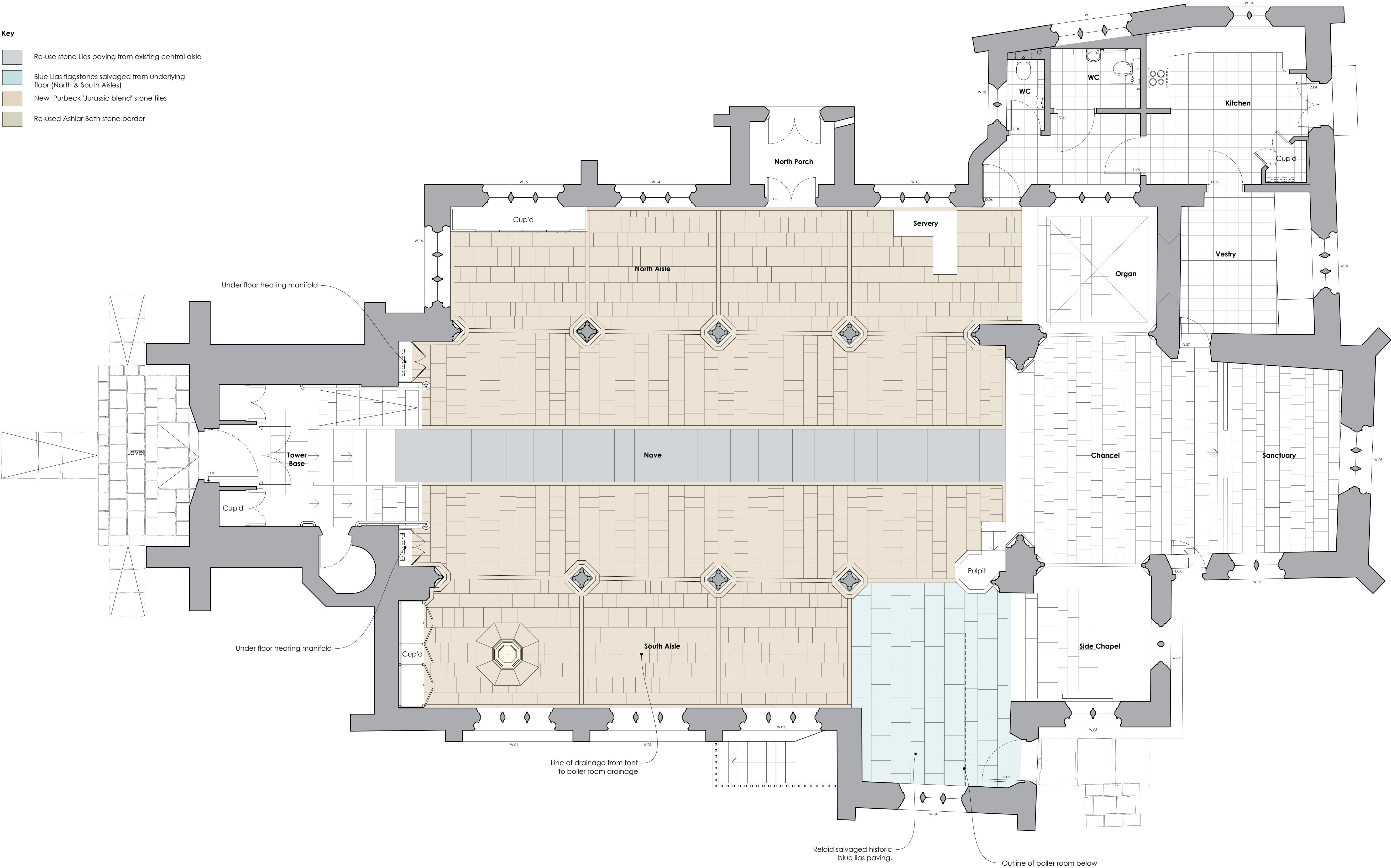

1:50  
metres

