

© This Drawing is the copyright of benjamin + beauchamp architects ltd.  
All dimensions to be checked on site by contractor and not scaled from this drawing.  
benjamin + beauchamp architects ltd accept no liability for any expense, loss or damage of whatsoever nature and however arising from any variation made to this drawing or in the execution of the work to which it relates, which has not been referred to them and their approval obtained.  
p:\glastonbury - st benedicts - 0875\drawings, photos & graphics\b2 drawings\drawing board\0875.S.004 existing underlying ground floor finishes plan.dwg

- Key**
- Weak limecrete /concrete slab approx 50mm thick. Original parquet floor tiles removed removed in 2014.
  - Historic flagstone paving
  - Cast iron grille
  - Outline of floor area to be lifted

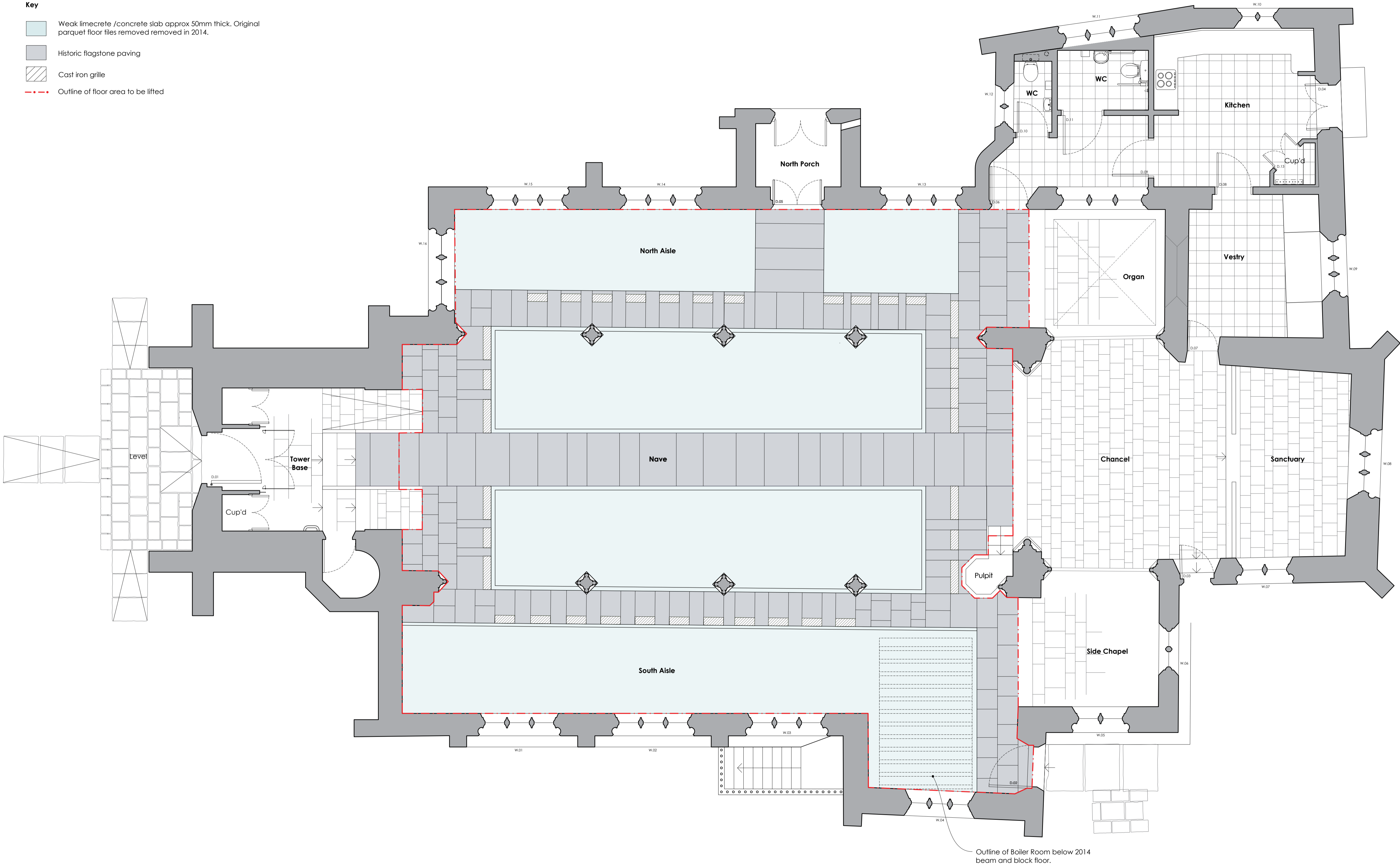

1:50  
metres 1 2 3 4 5

