

Red dashed line denotes existing partitions to be removed from both corners of tower.

Internal partitions built with ventilation gap to protect tower walls.

New extract ventilation through north wall of tower, and up and out through roof of boiler room. New water supply from boiler room.

New foul drainage above ground level through north wall of tower into boiler room to new connections beneath north path and connection to existing combined drainage to NE of church. Pump to be installed at MH1 to aid drainage from new WC and existing sink. Refer to drwg 040 proposed site plan

Panelled partition designed to be symmetrical, with vertical infill wedge-shaped sections cut to fit between edge of partition and lean of tower, required against both north and south walls. To be measured and formed on site for exact fit.

Existing timber partitions replaced with new painted timber panelled partitions as shown to enclose new accessible WC, min internal dimensions 1.5 x 2.2m, adjacent cleaning cupboard with low sink and storage cupboard to south side, all with symmetrical screen spanning from north to south walls of tower with a central panelled door. Painted plasterboard ceiling and tiled internal wall finish

Low level cleaners sink with water supply and drainage and timber shelves above within cupboard, with lockable door.

Design of new panelled partition and centrally repositioned font to maintain symmetry within floor of tower when viewed from the nave.

Stone floor slabs and ledger within tower to remain as existing. Repairs once font repositioned to be carried out with reclaimed stone to match.

A Section line

E D Section line

West Door to remain as existing (rarely used)

C Section line

Cupboard with painted plasterboard internal wall lining and painted skirting.

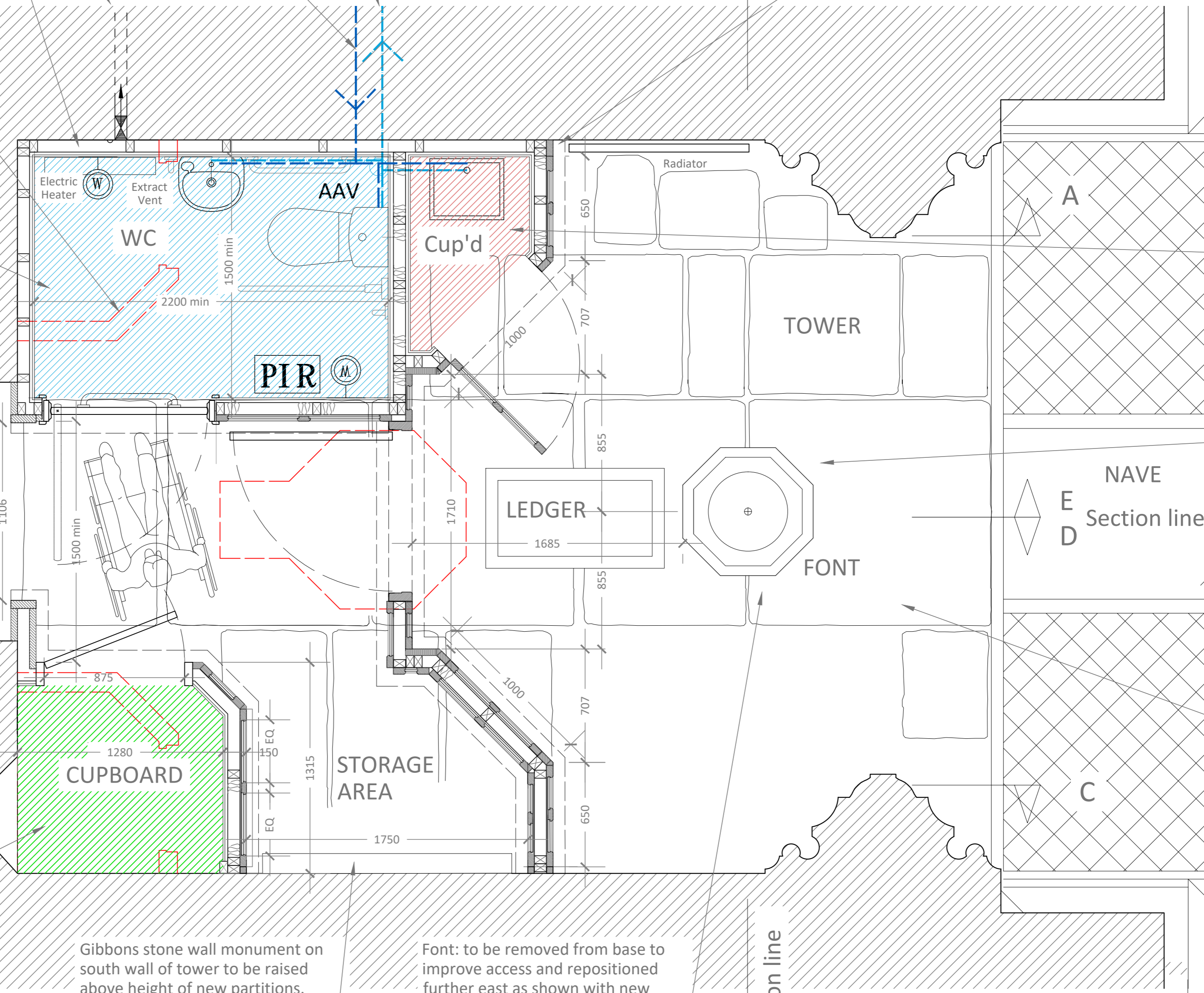

Gibbons stone wall monument on south wall of tower to be raised above height of new partitions. Smaller stone monument on north wall also to be raised to match.

Font: to be removed from base to improve access and repositioned further east as shown with new soakaway formed. Floor to be made good with reclaimed stone to match existing. Floor: existing stone flags to remain wherever possible.

PART PLAN: TOWER

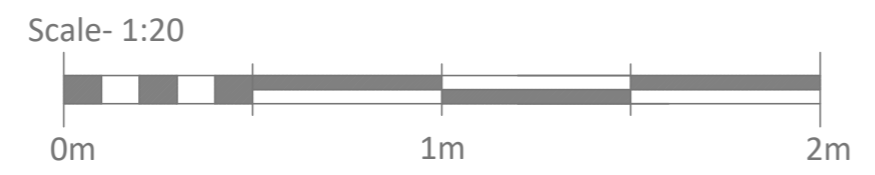

CHEDBURN • CODD
 CONSERVATION ARCHITECTS
 Historic Building Consultants

Glove Factory Studios, 1 Brook Lane, Holt, Bradford-on-Avon, Wiltshire BA14 6RL
 T: 01225 859999 www.chedburn.com e: chedburn@chedburn.com

| | | | |
|-------------|-----------------------------------|----------|--|
| Project | St Andrew's Church Burnham on Sea | | |
| Drawing | West End Tower Plan As Proposed | | |
| Stage | DAC Faculty | | |
| Drawing No. | Scale | Date | |
| 0609/100/ | 1:20 @ A2 | May 2024 | |