

**Options**

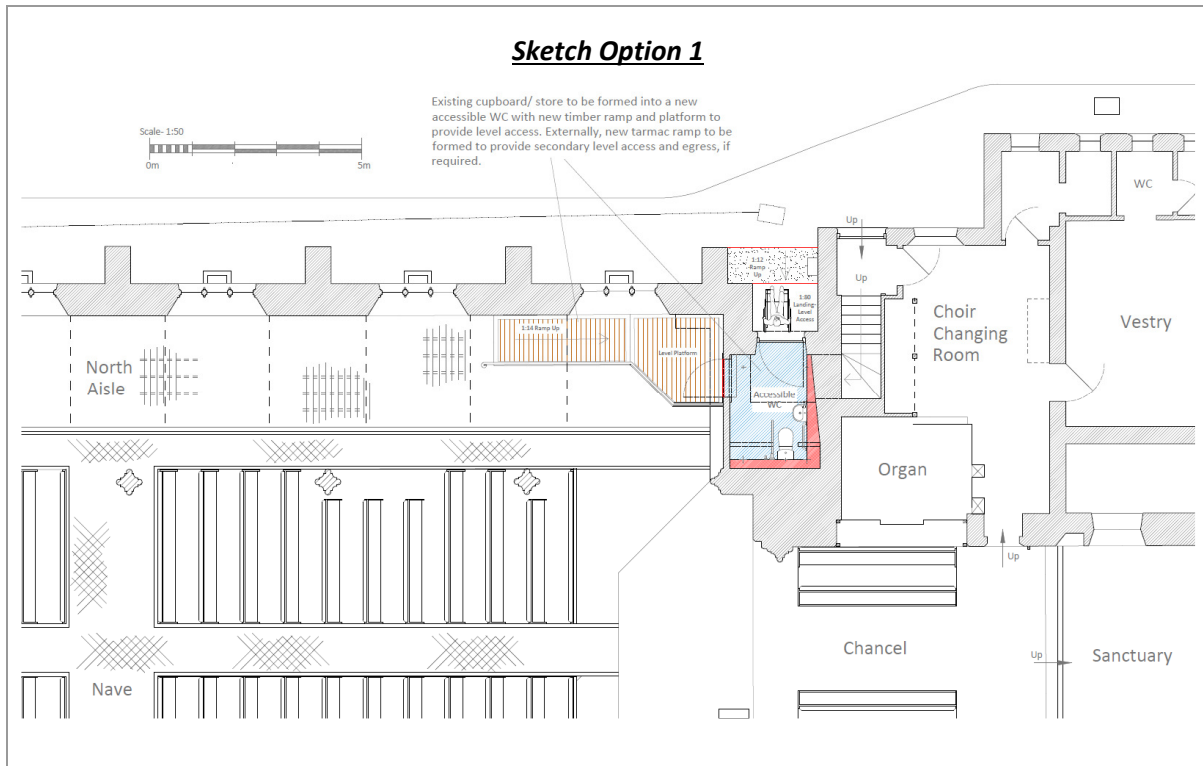

**Description:**

Sketch Option 1 included forming the existing cupboard to the east end of the North Aisle into an accessible WC with new timber ramp up to the existing level to provide level access. The existing external door retained for external access if required with existing tarmac path regraded, to provide level access.

**Advantages:**

- New facilities are accessible to all

**Disadvantages:**

- Large ramp required to provide level access up to existing level and over existing perimeter heating pipework within the North Aisle.
- Loss of moveable seating area within the North Aisle.
- Use of WC facilities would not be discrete during a service.
- Loss of a valuable storage area within the church.

**Conclusion:**

This sketch option provides the desired WC facilities, however the location has an impact on the current flexible space within the North Aisle and also the WC cannot be used discreetly during a service.

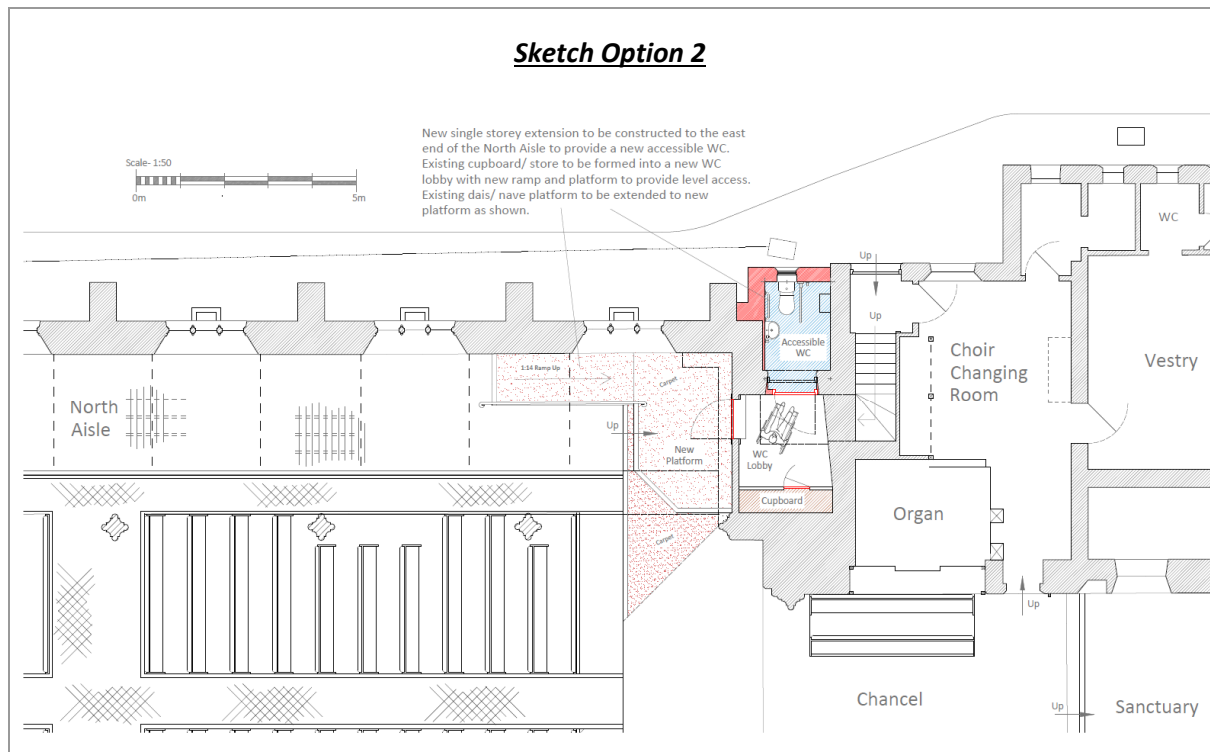
**Description:**

Sketch Option 2 included forming a new external accessible WC extension, between the east end of the North Aisle and choir changing rooms. The existing cupboard to the east end of the North Aisle formed into a lobby with new timber ramp up to the existing level to provide level access. The existing external door opening retained to provide access into the new WC extension.

**Advantages:**

- New facilities are accessible to all
- Lobby will provide additional privacy and help reduce noise from the WC area during services.
- Small area of storage retained within the existing cupboard.

**Disadvantages:**

- Large ramp required to provide level access up to existing level and over existing perimeter heating pipework within the North Aisle.
- Loss of moveable seating area within the North Aisle.
- Use of WC facilities would still not be discrete during a service.
- Loss of a valuable storage area within the church.
- An external WC extension would be of much greater cost than an internal WC option.

**Conclusion:**

This sketch option provides the desired WC facilities, however the location again has an impact on the current flexible space within the North Aisle and also the WC cannot be used discreetly during a service.

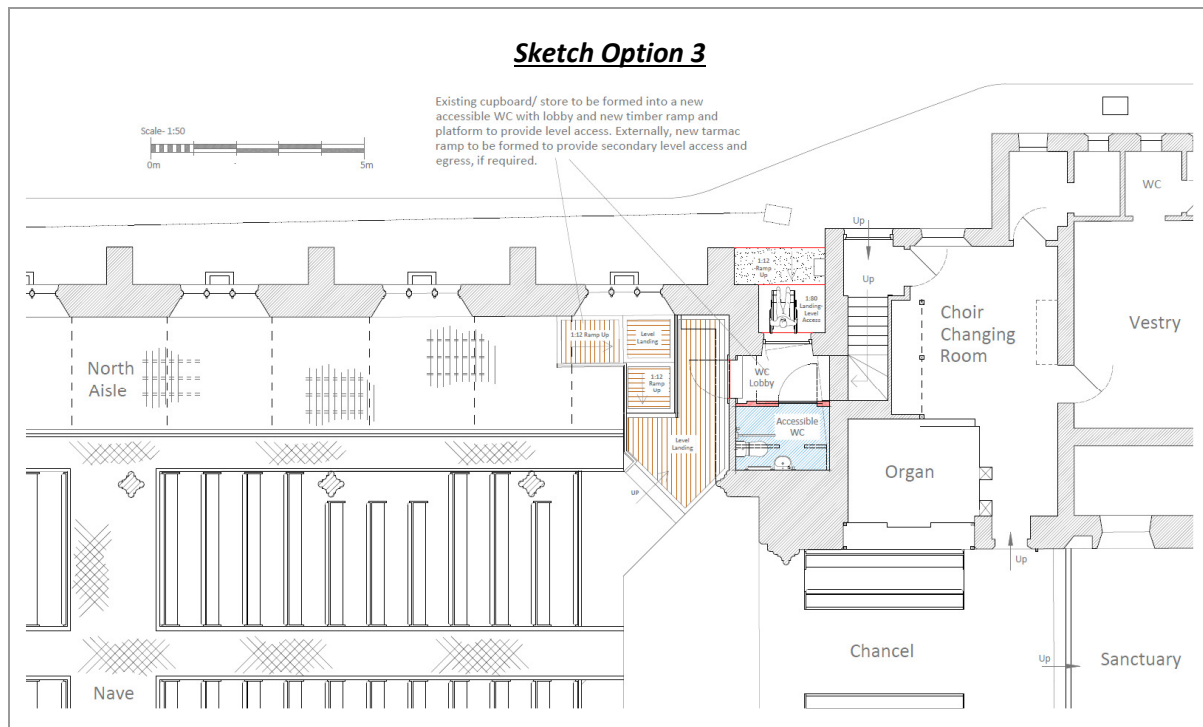
**Description:**

Sketch Option 3 included forming a new internal accessible WC within the existing cupboard to the east end of the North Aisle. A lobby formed within the space with new timber ramp up to the existing level to provide level access. The existing external door retained for external access if required with existing tarmac path regraded, to provide level access.

**Advantages:**

- New facilities are accessible to all
- Lobby will provide additional privacy and help reduce noise from the WC area during services.

**Disadvantages:**

- Large ramp required to provide level access up to existing level and over existing perimeter heating pipework within the North Aisle.
- Loss of moveable seating area within the North Aisle.
- Use of WC facilities would still not be discrete during a service.
- Loss of a valuable storage area within the church.

**Conclusion:**

This sketch option provides the desired WC facilities, however the location again has an impact on the current flexible space within the North Aisle and also the WC cannot be used discreetly during a service.

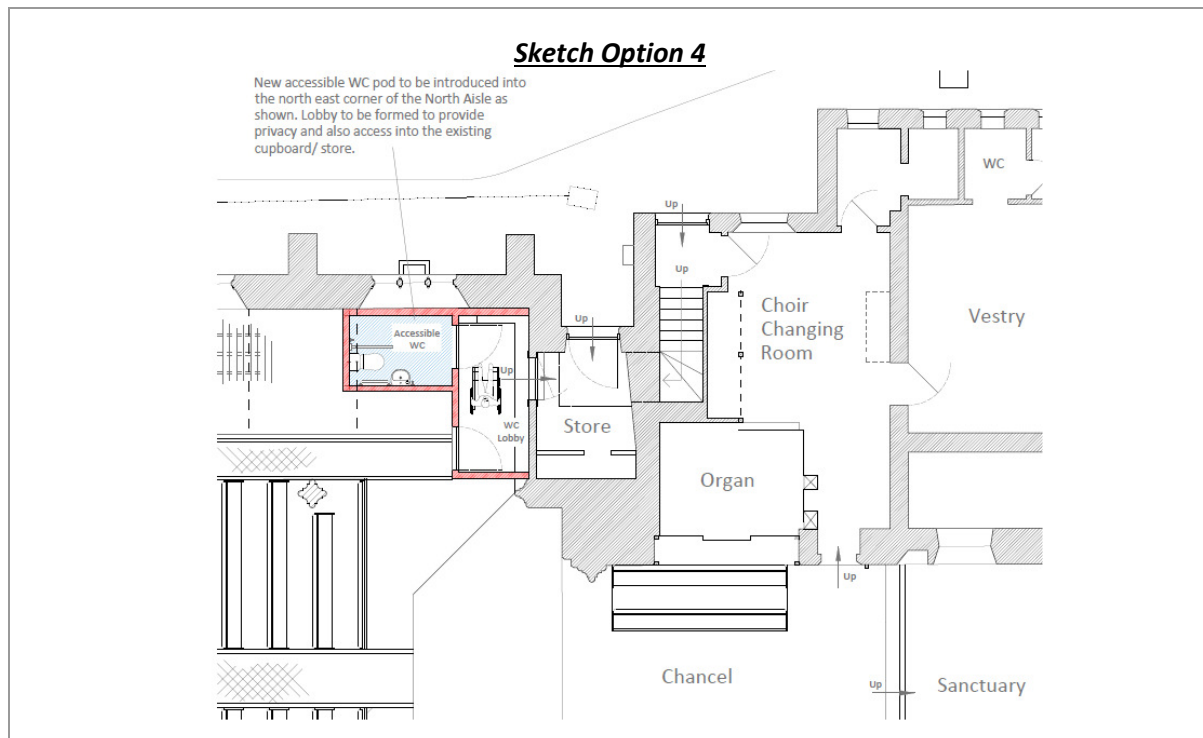
**Description:**

Sketch Option 4 included forming a new internal accessible WC pod at the east end of the North Aisle. A lobby formed with access to the WC and existing cupboard/ store.

**Advantages:**

- New facilities are accessible to all
- Lobby will provide additional privacy and help reduce noise from the WC area during services.
- No ramp required as the WC facilities are positioned at the same floor level as the North Aisle.

**Disadvantages:**

- Loss of moveable seating area within the North Aisle.
- Use of WC facilities would still not be discrete during a service.
- Loss of natural light and view of window to the east end of the North Aisle.

**Conclusion:**

This sketch option provides the desired WC facilities, however the location again has an impact on the current flexible space within the North Aisle, the WC cannot be used discreetly during a service and the existing window is blocked.

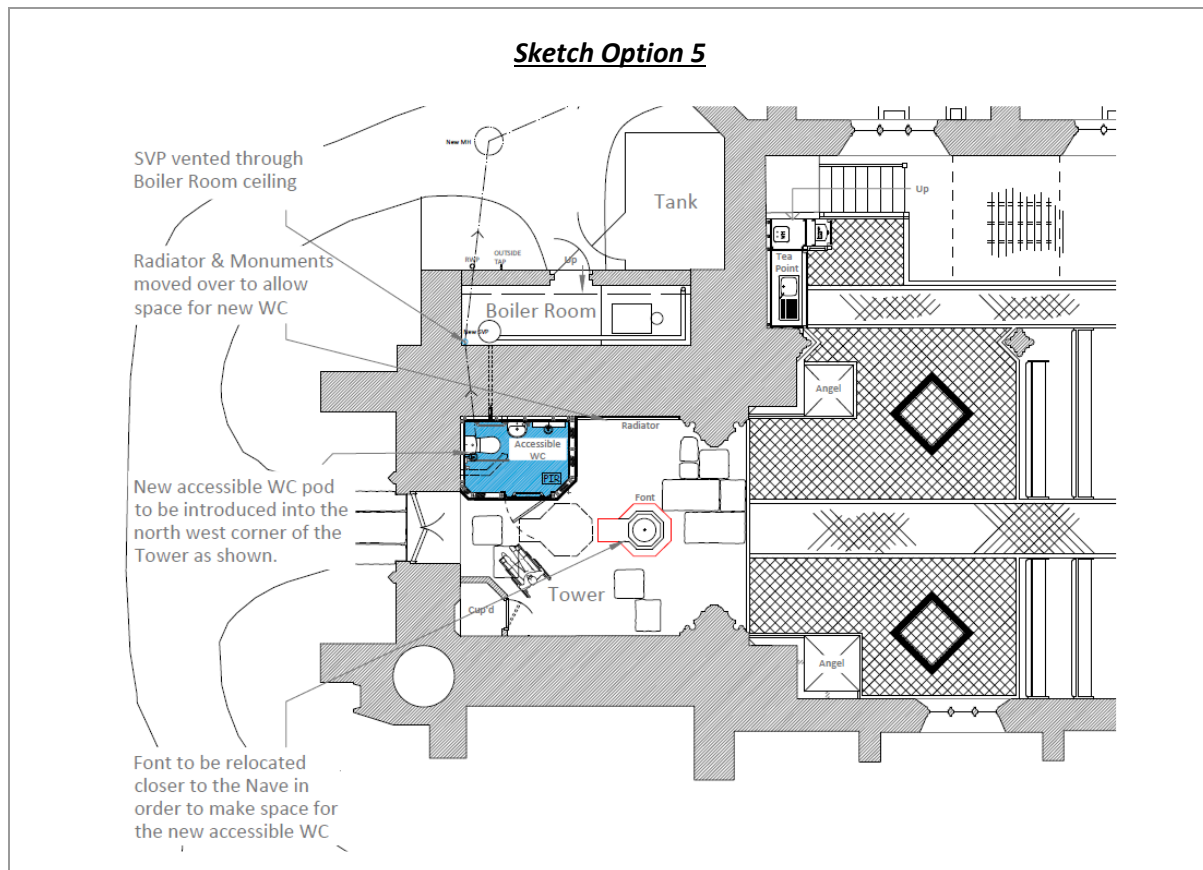
**Description:**

Sketch Option 5 (**proposed scheme**) includes removing an existing cupboard and forming a new internal accessible WC pod at the base of the tower and relocation of the font to provide clear access to the new facilities.

**Advantages:**

- New facilities are accessible to all
- The facilities are to the rear of the church and can be used more discreetly during a service.
- No ramp required as the WC facilities are positioned at the same floor level as the Tower/ Nave.
- The WC pod will be designed to replicate the style and detailing of the adjacent cupboard.

**Disadvantages:**

- Loss of storage cupboard at the base of the tower.
- Relocation of existing wall monuments will be required.
- Longer drainage run required due to distance from existing foul drainage system compared to other options at the east end.

**Conclusion:**

This sketch option (**the proposed scheme**) includes amendments and alterations which were highlighted in all of the previous schemes. The proposal meets the requirements of the church members and sensitively offers the accessible WC facilities which has minimal impact on the church fabric, layout and use.