

West Wall

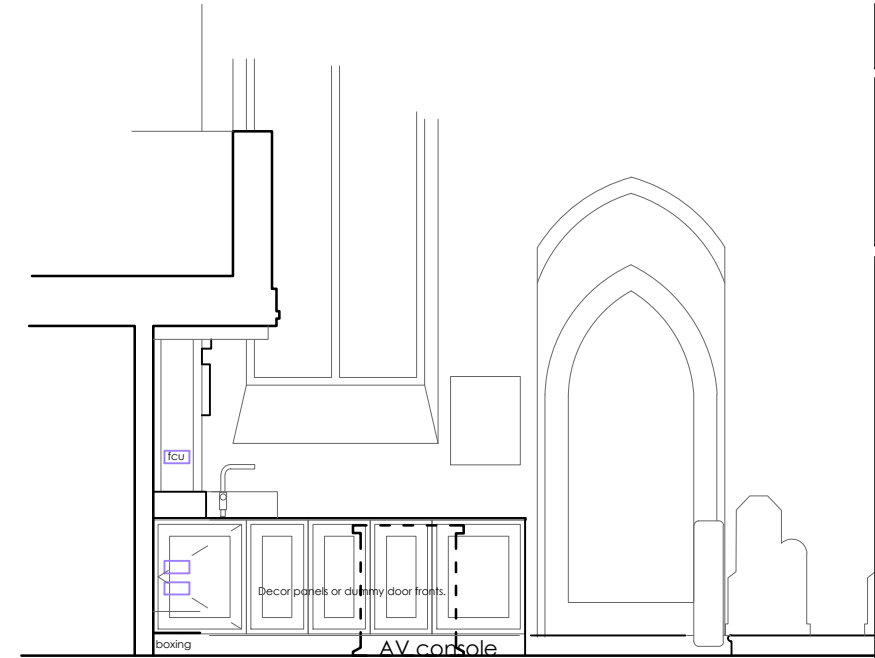

Section A



North Wall

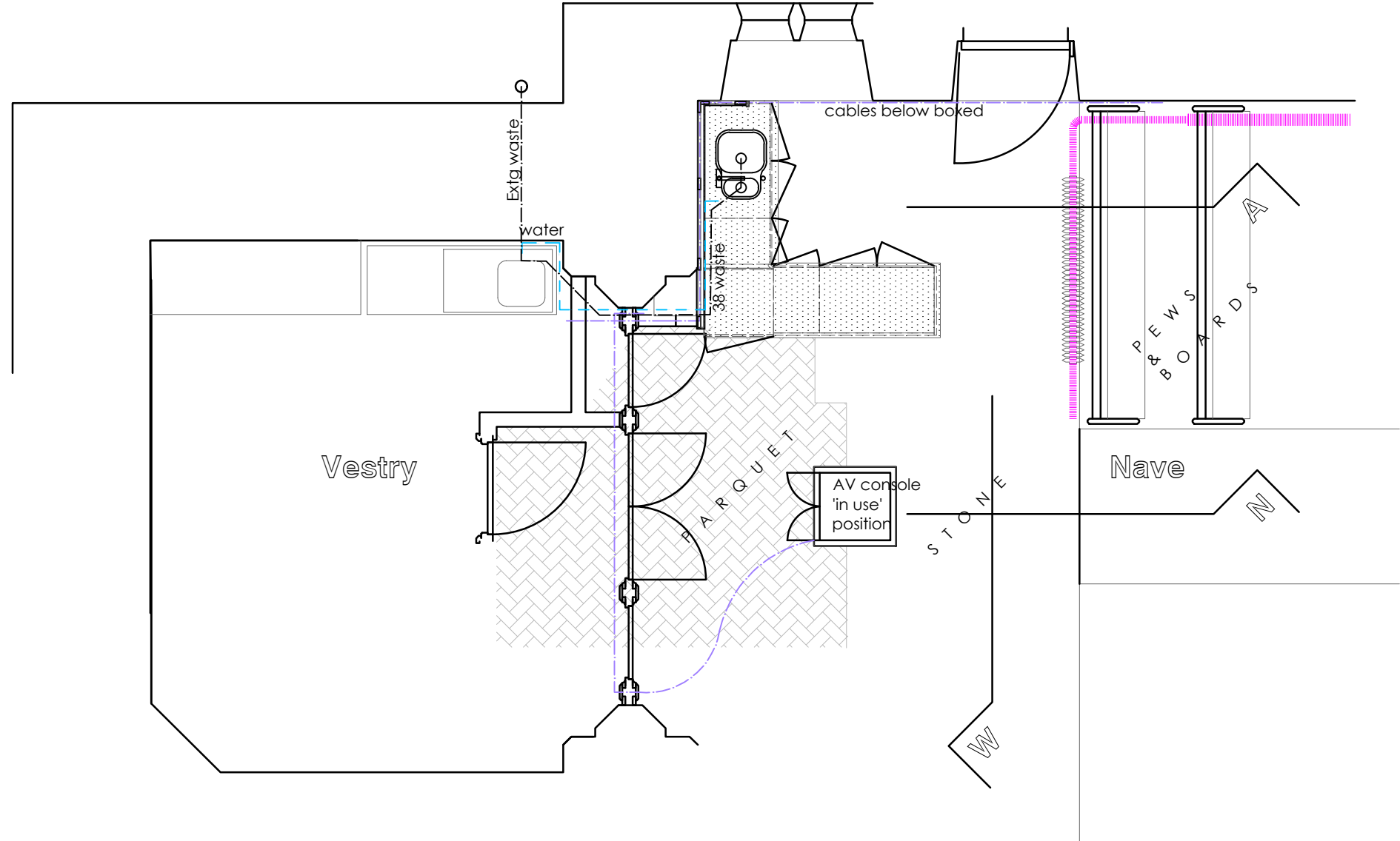

Rev C: -/mb/12-03-19 AB
Rev B: -/mb/18-04-18/ cover omitted
Rev A: -/mb/08-04-18/removable cover

DRAWING STAGE	
F= Feasibility	AB
P= Planning stages	
BR= Building Regulations	
W= Working Drawings	
AB= As built	

CLIENT:
PCC
St Marys Church
Studley

PROJECT:
Hot drinks facility

TITLE:
PART PLAN & WALL ELEVATIONS
PROPOSED

masefields
architects ■ surveyors
Doric House, Church St., Studley Warwickshire B80 7LG
Tel: 01527 910190
Email: architecture@masefields.co.uk
IN ASSOCIATION WITH:

ASA Alan Smith Associates
■ CHARTERED ARCHITECTS ■
PLANNING and DEVELOPMENT CONSULTANTS

Drawn RS	Ratio 1:25@A1	Checked mb	
Date APR 18	Job No 3207	Drg No 10	Rev C